

Welcome



Your C330 Series phone lets you change covers and keypads (see “Changing Your Phone’s Cover” on page 24). Your phone may not appear exactly as the phone image above.

Note that all key locations, sequences and functions remain the same with any of the various covers.



www.motorola.com

MOTOROLA, the Stylised M Logo and all other trademarks indicated as such herein are trademarks of Motorola, Inc. © Reg. U.S. Pat. & Tm. Off. All other product or service names are the property of their respective owners.

© 2002 Motorola, Inc. All rights reserved. Printed in the U.S.A.

Software Copyright Notice

The Motorola products described in this manual may include copyrighted Motorola and third party software stored in semiconductor memories or other media. Laws in the United States and other countries preserve for Motorola and third party software providers certain exclusive rights for copyrighted software, such as the exclusive rights to distribute or reproduce the copyrighted software. Accordingly, any copyrighted software contained in the Motorola products may not be modified, reverse-engineered, distributed, or reproduced in any manner to the extent allowed by law. Furthermore, the purchase of the Motorola products shall not be deemed to grant either directly or by implication, estoppel, or otherwise, any licence under the copyrights, patents, or patent applications of Motorola or any third party software provider, except for the normal, non-exclusive, royalty-free licence to use that arises by operation of law in the sale of a product.



Menu Map





Main Menu

- Recent Calls
- Ring Styles
- Media Centre
 - My Tones
 - MotoMixer
 - Picture Viewer
- Chat
- Games
- Browser *
- Web Sessions *
- Datebook
- Voice Dial
- Quick Dial
- Calculator
- Settings
 - (see next page)
- SIM Applications *
- MyMenu
- Service Dial
- Fixed Dial
- Phonebook
- Messages

Note: This is the standard phone menu layout. You or your service provider may have changed the menu layout or changed some feature names.

Not all features may be available for all users.

* optional network, SIM card, or subscription-dependent features

Shortcuts
In idle, press  up or down to open Phonebook , right or left to adjust volume
Display my phone number: Press  
Go to dialled calls list: Press 
Exit menu system: Press 

See page 58 for MyMenu Shortcuts

Settings Menu

Call Divert *

- Voice Calls
- Fax Calls
- Data Calls
- Cancel All
- Divert Status

Phone Status

- My Tel. Numbers *
- Credit Info/Available *
- Active Line
- Battery Meter
- Other Information

In-Call Setup

- In-Call Timer
- Call Cost Setup *
- My Caller ID
- Talk and Fax
- Answer Options
- Call Waiting *

Security

- Phone Lock
- Lock Keypad
- Lock Application
- Fixed Dial
- Call Barring *
- SIM PIN
- New Passwords

• Other Settings

Personalize

- Main Menu
- Keys
- Greeting
- Wallpaper
- Screensaver
- Quick Dial

Initial Setup

- Time and Date
- 1-Touch Dial
- Backlight
- Scroll
- Animation
- Language
- Battery Save
- Contrast
- DTMF
- Master Reset
- Master Clear

Network

- Car Settings
- Headset

Note: This is the standard phone menu layout. You or your service provider may have changed the menu layout or changed some feature names.

Not all features may be available for all users.

* optional network, SIM card, or subscription-dependent features



Table of Contents

Safety and General Information	9
Warranty Information	16
How to get Warranty Service?	17
Conditions	18
What is not covered by the Warranty	19
Getting Started	21
What's in the Box?	21
About This Guide	21
Changing Your SIM Card	22
Changing Your Phone's Cover	24
Resetting Your Phone	27
Charging the Phone	28
Battery Use	29
Turning Your Phone On	29
Adjusting the Volume	30
Making and Answering Calls	30
Using Your Phone	33
Display Symbols	33
Using the Menu	35
Setting Up Your Phone	36
Entering Text	40

Calling Features	43
Redialing a Number	43
Using Caller ID	43
Dialing an Emergency Number	44
Inserting Special Characters into Dialing Sequences	44
Viewing Recent Calls	45
Using Voicemail	45
Speed Dialing	46
One-Touch Dialing	46
Using Call Waiting	47
Diverting a Call	47
Linking Calls	48
Transferring a Call	48
Barring a Call	48
Putting a Call on Hold	48
Messages	49
Sending Messages, Pictures, and Sounds	49
Viewing Message Status	50
Receiving and Reading Messages	51
Phonebook	53
Items in a Phonebook Entry	53
Storing a Phonebook Entry	54
Dialing a Phonebook Entry	55
Editing a Phonebook Entry	56
Customising Your Phone Settings	57
Customising Menus and Display	57
Using MyMenu	58

Getting More Out of Your Phone	59
Dialing Options	59
Monitoring Phone Use	60
Network Features	61
Security	63
Line Security	63
Locking and Unlocking Your Phone	63
Changing Your Unlock Code	64
Protecting the SIM Card	64
Protecting Web Transactions	65
Personal Organizer Features	67
Datebook	67
Alarm Reminders	68
Calculator	68
News and Entertainment	69
Mobile Internet	69
Assigning Phone Themes	71
Games	71
MotoMixer Sound Editor	73
Creating Alert Tones	73
SIM Applications	74
Troubleshooting	75
Specific Absorption Rate Data	77
Index	79





Safety and General Information

IMPORTANT INFORMATION ON SAFE AND EFFICIENT OPERATION.
READ THIS INFORMATION BEFORE USING YOUR PERSONAL
COMMUNICATOR.

The information provided in this document supersedes the general safety information contained in user guides published prior to this date. For information regarding radio use in a hazardous atmosphere please refer to the Factory Mutual (FM) Approval Manual Supplement or Instruction Card, which is included with radio models that offer this capability.

RF Operational Characteristics

Your Personal Communicator contains a transmitter and a receiver. When it is ON, it receives and transmits radio frequency (RF) energy. The Personal Communicator operates in the frequency range of 900 MHz to 1990 MHz and employs digital modulation techniques.

When you communicate with your Personal Communicator, the system handling your call controls the power level at which your personal communicator transmits. The output power level typically may vary over a range from 0.063 watts to 1.58 watts.

Exposure To Radio Frequency Energy

Your Motorola Personal Communicator is designed to comply with the following national and international standards and guidelines regarding exposure of human beings to radio frequency electromagnetic energy:

- United States Federal Communications Commission, Code of Federal Regulations; 47 CFR part 2 sub-part J
- American National Standards Institute (ANSI) /
Institute of Electrical and Electronic Engineers (IEEE) C95. 1-1992





- Institute of Electrical and Electronic Engineers (IEEE)
C95.1-1999 Edition
- National Council on Radiation Protection and Measurements (NCRP) of the United States, Report 86, 1986
- International Commission on Non-Ionizing Radiation Protection (ICNIRP) 1998
- National Radiological Protection Board of the United Kingdom 1995
- Ministry of Health (Canada) Safety Code 6. Limits of Human Exposure to Radiofrequency Electromagnetic Fields in the Frequency Range from 3 kHz to 300 GHz, 1999
- Australian Communications Authority Radiocommunications (Electromagnetic Radiation - Human Exposure) Standard 1999 (applicable to wireless phones only)

To assure optimal performance and make sure human exposure to radio frequency electromagnetic energy is within the guidelines set forth in the above standards, always adhere to the following procedures:

Portable Personal Communicator Operation and EME Exposure

Antenna Care

Use only the supplied or an approved replacement antenna. Unauthorized antennas, modifications, or attachments could damage the Personal Communicator and may violate FCC and/or other applicable regulations.

DO NOT hold the antenna when the Personal Communicator is "N USE". Holding the antenna affects call quality and may cause the Personal Communicator to operate at a higher power level than needed.





Phone Operation

The Personal Communicator is designed to be used with a headset for talking and listening. The Personal Communicator can also be placed inside the holster, then the holster can be clipped onto your belt, pocket, handbag, or other apparel and used with the headset.

Body-Worn Operation

To maintain compliance with FCC RF exposure guidelines, if you wear the Personal Communicator on your body when transmitting, always place the Personal Communicator in a Motorola supplied or approved clip, holder, holster, case, or body harness. Use of non-Motorola-approved accessories may exceed FCC RF exposure guidelines. If you do not use a body-worn accessory, ensure the antenna is at least one inch (2.5 cm) from your body when transmitting.

Approved Accessories

For a list of approved Motorola accessories, look in the accessory section of this manual.

Electromagnetic Interference/Compatibility

Nearly every electronic device is susceptible to electromagnetic interference (EMI) if inadequately shielded, designed or otherwise configured for electromagnetic compatibility.

Facilities

To avoid electromagnetic interference and/or compatibility conflicts, turn off your Personal Communicator in any facility where posted notices instruct you to do so. Hospitals or health care facilities may be using equipment that is sensitive to external RF energy.





Aircraft

When instructed to do so, turn off your Personal Communicator when on board an aircraft. Any use of a Personal Communicator must be in accordance with applicable regulations per airline crew instructions.

Medical Devices

Pacemakers

The Health Industry Manufacturers Association recommends that a minimum separation of 6 inches (15 centimeters) be maintained between a handheld wireless phone and a pacemaker. These recommendations are consistent with the independent research by, and recommendations of, Wireless Technology Research.

Persons with pacemakers should:

- ALWAYS keep the Personal Communicator more than six inches (15 centimeters) from their pacemaker when the Personal Communicator is turned ON.
- not carry the Personal Communicator in the breast pocket.
- use the ear opposite the pacemaker to minimize the potential for interference.
- turn the Personal Communicator OFF immediately if you have any reason to suspect that interference is taking place.

Hearing Aids

Some digital wireless phones may interfere with some hearing aids. In the event of such interference, you may want to consult your hearing aid manufacturer to discuss alternatives.





Other Medical Devices

If you use any other personal medical device, consult the manufacturer of your device to determine if it is adequately shielded from RF energy. Your physician may be able to assist you in obtaining this information.

Safety and General Use in Vehicles

Check the laws and regulations on the use of phones in your vehicle. You are advised to always obey them.

When using your Personal Communicator in a vehicle, please:

- Use hands-free operation, if available.
- Pull off the road and park before making or answering a call.

Operational Warnings

For Vehicles With an Air Bag

Do not place the Personal Communicator in the area over an air bag or in the air bag deployment area. Air bags inflate with great force. If the Personal Communicator is placed in the air bag deployment area and the air bag inflates, the Personal Communicator may be propelled with great force and cause serious injury to occupants of the vehicle.

Potentially Explosive Atmospheres

Turn off your Personal Communicator prior to entering any area with a potentially explosive atmosphere, unless it is especially qualified for use in such areas as "Intrinsically Safe" (for example, Factory Mutual, CSA, or UL Approved). Do not remove, install, or charge batteries in such areas. Sparks in a potentially explosive atmosphere can cause an explosion or fire resulting in bodily injury or even death.





The areas with potentially explosive atmospheres referred to above include fueling areas such as below decks on boats, fuel or chemical transfer or storage facilities, areas where the air contains chemicals or particles, such as grain, dust or metal powders, and any other area where you would normally be advised to turn off your vehicle engine. Areas with potentially explosive atmospheres are often but not always posted.

Blasting Caps and Areas

To avoid possible interference with blasting operations, turn off your Personal Communicator when you are near electrical blasting caps, in a blasting area, or in areas posted: "Turn off two-way radio". Obey all signs and instructions.

Operational Cautions

Antennas

Do not use the Personal Communicator if it has a damaged antenna. If a damaged antenna comes into contact with your skin, a minor burn can result.

Batteries

All batteries can cause property damage and/or bodily injury such as burns if a conductive material such as jewelry, keys, or beaded chains touch exposed terminals. The conductive material may complete an electrical circuit (short circuit) and become quite hot. Exercise care in handling any charged battery, particularly when placing it inside a pocket, purse, or other container with metal objects.



European Union Directives Conformance Statement

Hereby, Motorola declares that this product is in compliance with



- The essential requirements and other relevant provisions of Directive 1999/5/EC
- All other relevant EU Directives

The above gives an example of a typical Product Approval Number.

You can view your product's Declaration of Conformity (DoC) to Directive 1999/5/EC (the R&TTE Directive) at www.motorola.com/rtte - to find your DoC, enter the Product Approval Number from your product's label in the "Search" bar on the Web site.

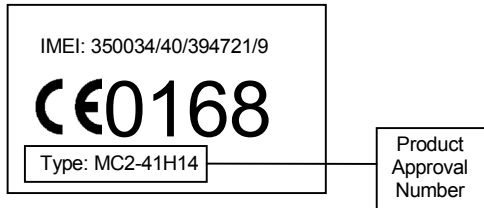



Warranty Information

Motorola guarantees you, the original purchaser, the Personal Communicator and accessories which you have purchased from an authorised Motorola dealer (the "Products"), to be in conformance with the applicable Motorola specifications current at the time of manufacture for a term of [1] year from date of purchase of the Product(s) (Warranty Term).

You must inform Motorola of the lack of conformity to the applicable specifications of any of the Products within a period of two (2) months from the date on which you detect a defect in material, workmanship or lack of conformity and in any event within a term not to exceed the Warranty Term, by submitting the Product for service to Motorola. Motorola shall not be bound by Product related statements not directly made by Motorola nor any warranty obligations applicable to the seller.

A list of the Motorola Call Centre numbers is enclosed with this Product.

During the Warranty term, Motorola will, at its discretion and without extra charge, as your exclusive remedy, repair or replace your Product which does not comply with this warranty; or failing this, to reimburse the price of the Product but reduced to take into account the use you have had of the Product since it was delivered. This warranty will expire at the end of the Warranty Term.

This is the complete and exclusive warranty for a Motorola Personal Communicator and accessories and in lieu of all other warranties, terms and conditions, whether express or implied.

Where you purchase the product other than as a consumer, Motorola disclaims all other warranties, terms and conditions express or implied, such as fitness for purpose and satisfactory quality.





In no event shall Motorola be liable for damages nor loss of data in excess of the purchase price nor for any incidental special or consequential damages* arising out of the use or inability to use the Product, to the full extent such may be disclaimed by law.

This Warranty does not affect any statutory rights that you may have if you are a consumer, such as a warranty of satisfactory quality and fit for the purpose for which products of the same type are normally used under normal use and service, nor any rights against the seller of the Products arising from your purchase and sales contract.

How to get Warranty Service?

In most cases the authorised Motorola dealer which sold and/or installed your Motorola Personal Communicator and original accessories will honour a warranty claim and/or provide warranty service. Alternatively, for further information on how to get warranty service please contact either the customer service department of your service provider or Motorola's call centre at the telephone numbers below for your country.

In order to claim the warranty service you must return the Personal Communicator and/or accessories in question to Motorola please avoid leaving any supplementary items like SIM cards. The Product should also be accompanied by a label with your name, address, and telephone number; name of operator and a description of the problem. In the case of vehicular installation, the vehicle in which the Personal Communicator is installed should be driven to the Authorised Repair Centre, as analysis of any problem may require inspection of the entire vehicular installation.

*) including without limitation loss of use, loss of time, loss of data, inconvenience, commercial loss, lost profits or savings.





In order to be eligible to receive warranty service, you must present your receipt of purchase or a comparable substitute proof of purchase bearing the date of purchase. The phone should also clearly display the original compatible electronic serial number (IMEI) and mechanic serial number [MSN]. Such information is contained with the Product.

Conditions

This warranty will not apply if the type or serial numbers on the Product has been altered, deleted, duplicated, removed, or made illegible.

Motorola reserves the right to refuse free-of-charge warranty service if the requested documentation can not be presented or if the information is incomplete, illegible or incompatible with the factory records.

Repair, at Motorola's option, may include reflashing of software, the replacement of parts or boards with functionally equivalent, reconditioned or new parts or boards. Replaced parts, accessories, batteries, or boards are warranted for the balance of the original warranty time period. The Warranty Term will not be extended. All original accessories, batteries, parts, and Personal Communicator equipment that have been replaced shall become the property of Motorola. Motorola does not warrant the installation, maintenance or service of the products, accessories, batteries or parts.

Motorola will not be responsible in any way for problems or damage caused by any ancillary equipment not furnished by Motorola which is attached to or used in connection with the Products, or for operation of Motorola equipment with any ancillary equipment and all such equipment is expressly excluded from this warranty.





When the Product is used in conjunction with ancillary or peripheral equipment not supplied by Motorola, Motorola does not warrant the operation of the Product/peripheral combination and Motorola will not honour any warranty claim where the Product is used in such a combination and it is determined by Motorola that there is no fault with the Product. Motorola specifically disclaims any responsibility for any damage, whether or not to Motorola equipment, caused in any way by the use of the Personal Communicator, accessories, software applications and peripherals (specific examples include, but are not limited to: batteries, chargers, adapters, and power supplies) when such accessories, software applications and peripherals are not manufactured and supplied by Motorola.





What is not covered by the Warranty



This warranty is not valid if the defects are due to damage, misuse, tampering, neglect or lack of care and in case of alterations or repair carried out by unauthorised persons.

- 1 Defects or damage resulting from use of the Product in other than its normal and customary manner.
- 2 Defects or damage from misuse, access to incompatible sources, accident or neglect.
- 3 Defects or damage from improper testing, operation, maintenance, installation, adjustment, unauthorised software applications or any alteration or modification of any kind.
- 4 Breakage or damage to antennas unless caused directly by defects in material or workmanship.

- 
- 5 Products disassembled or repaired in such a manner as to adversely affect performance or prevent adequate inspection and testing to verify any warranty claim.
 - 6 Defects or damage due to range, coverage, availability, grade of service, or operation of the cellular system by the cellular operator.
 - 7 Defects or damage due to moist, liquid or spills of food.
 - 8 Control unit coil cords in the Product that are stretched or have the modular tab broken.
 - 9 All plastic surfaces and all other externally exposed parts that are scratched or damaged due to customer normal use.
 - 10 Leather cases (which are covered under separate manufacturer's warranties).
 - 11 Products rented on a temporary basis.
 - 12 Periodic maintenance and repair or replacement of parts due to normal wear and tear.



Note: The talk-time, stand-by time and total life cycle of a Motorola rechargeable battery for your Personal Communicator will depend on usage conditions and network configurations. As a consumable product, the specifications indicate that you should be able to obtain optimum performance for your Motorola Personal Communicator within the first six months from date of purchase and up-to (200) charges.

The warranty for Motorola rechargeable batteries becomes void if

- (i) the batteries are charged other than by Motorola approved battery chargers specified for the charging of the battery,
 - (ii) any of the seals on the battery are broken or show evidence of tampering,
 - (iii) the battery is used in equipment or service other than the cellular telephone equipment for which it is specified.
- 



Getting Started

What's in the Box?

Your digital wireless phone has a permanent internal battery, and typically comes equipped with a charger. Other accessory options can customise your phone for maximum performance and portability.

About This Guide

Optional Features



Features marked with this label are optional network, SIM card, and/or subscription-dependent features. These features may not be offered by all service providers in all geographical areas. Contact your service provider for information about availability.

Optional Accessories



Features marked with this label require the use of an optional Motorola Original™ accessory.

Changing Your SIM Card

Your SIM (Subscriber Identity Module) card contains your phone number, service details, and phonebook/message memory. It must be installed in the base of the phone.

Caution: Do not bend or scratch your SIM card. Avoid exposing your SIM card to static electricity, water, or dirt.

Note: Since your C330 Series phone lets you change covers and keypads, it may not appear exactly as the phone pictured. All key locations, sequences, and functions remain the same with any of the various covers.

To Change Your SIM Card

- 1 Press down on the cover release button at the top of your phone.
- 2 Pull the top of the phone's back cover to release it.

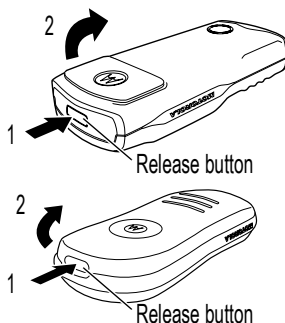

To Change Your SIM Card

- 3 Slide the metal SIM card holder back to unlock it, then lift up to open it slightly. Remove the old SIM card, if necessary.

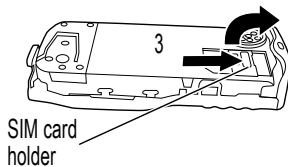

- 4 Insert the new SIM card in the holder with the cut corner on the upper left and the gold plate facing down.
- 5 Close the SIM card holder and slide it forward to lock it.

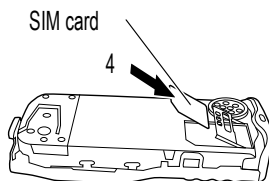

Changing Your Phone's Cover

Note: Since your C330 Series phone lets you change covers and keypads, it may not appear exactly as the phone pictured. All key locations, sequences, and functions remain the same with any of the various covers.

To Remove a Cover and Keypad

- 1 Press down on the cover release button at the top of your phone.
- 2 Pull the top of the phone's back cover to release it.

Note: If your cover has a removable side band, remove it at this point.

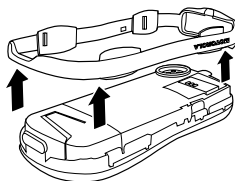
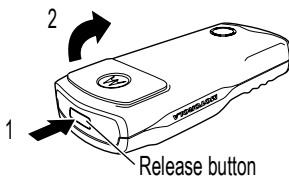

To Remove a Cover and Keypad

- 3 Pull the side tabs away from the phone. Lift up on the bottom of the phone to pull it out of the front cover.

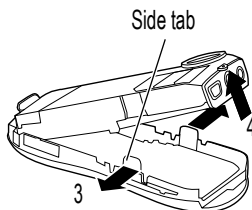
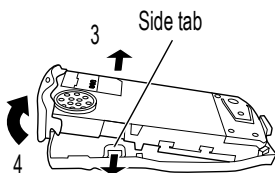

Note: Always use Motorola Original™ covers. The phone warranty does not cover damage caused from using non-Motorola accessories.

Always use the keypad and side band (if applicable) that matches the new cover.

To Install a Cover and Keypad

- 1 Slide the top of the phone into the top of the new front cover.
- 2 Press the bottom of the phone into the front cover until the side tabs snap into place.

Note: If your cover has a removable side band, attach it at this point.

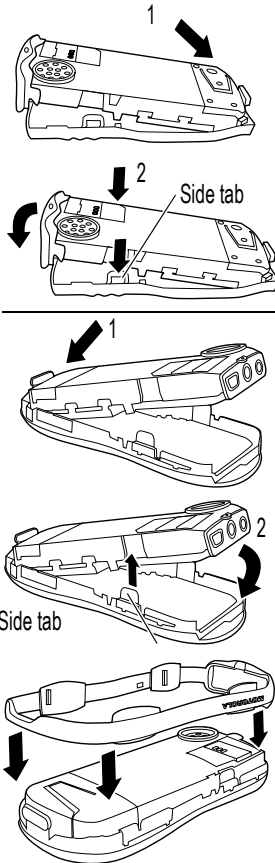

To Install a Cover and Keypad

- 3 Insert the bottom of the back cover.
- 4 Press the top of the back cover down until it hooks over the cover release button.

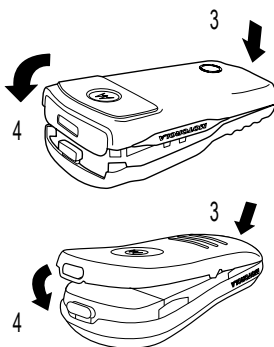

Resetting Your Phone

If your phone becomes frozen on a single display, error message, or power up, reset your phone as follows:

To Reset Your Phone

- 1 Remove your phone's back and front cover as described in "Changing Your Phone's Cover" on page 24.
- 2 Use a small object to press the Reset button on the front of your phone.

Your phone display should be restored.

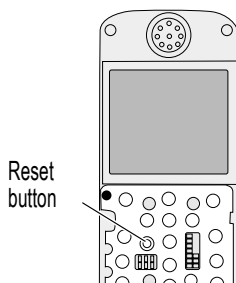

- 3 Replace your phone's cover.

Charging the Phone

Your phone has a built-in battery. Before you can use your phone, you need to fully charge the battery, as indicated by the following instructions. Some batteries perform best after several full charge/discharge cycles.

To Charge the Phone

- 1 Plug the travel charger into the middle jack on the bottom of your phone.

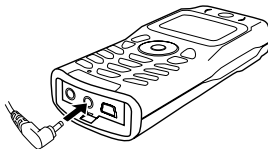

- 2 Plug the other end of the travel charger into the appropriate electrical outlet.
- 3 When your phone indicates that it is fully charged (**Charge Complete**), remove the travel charger.

Note: When you charge the battery, the battery level indicator in the upper right corner of the display shows how much of the charging process is complete. See the “Battery Level Indicator” item on page 33.

Battery Use

Your C330 Series phone has a permanent internal battery. To maximise your battery's performance:

- Always use Motorola Original™ battery chargers. The phone warranty does not cover damage caused from using non-Motorola battery chargers.
- New phones or phones that have been stored for long periods of time may require a longer initial charge time.
- Maintain the phone at or near room temperature when charging.
- Do not expose phones to temperatures below -10°C (14°F) or above 45°C (113°F). Always take your phone with you when you leave your vehicle.

Turning Your Phone On

To Turn Your Phone On

- 1 Press and hold  (the End/Power key.)

End/
Power Key



- 2 If necessary, enter your SIM card PIN code and press **OK** () to unlock your SIM card.

Note: If you enter an incorrect PIN code three times in a row, your SIM card is disabled and your phone displays the message **SIM Blocked**. (For more information, see “Protecting the SIM Card” on page 64.)

To Turn Your Phone On

- 3 If necessary, enter your four-digit unlock code and press **OK** () to unlock your phone.

Note: The unlock code is originally set to 1234. (For more information, see “Locking and Unlocking Your Phone” on page 63.)

Adjusting the Volume

You can adjust your phone's earpiece and ring tone volume by pressing right and left on the :

When	You Can Adjust
you are in a call	earpiece speaker volume
the display is idle	ring tone volume

Making and Answering Calls

This section summarises the most basic calling features. For more features, see “Calling Features” on page 43.

Making a Call

There is a built-in antenna in the top of your phone. Do not block the antenna while you are on a call.

To call a number, your phone must:

- be turned on and unlocked
- have a SIM card inserted and unlocked
- have a network connection with adequate signal strength

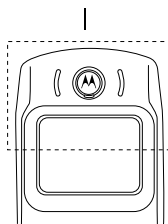

Built-in antenna







To Make a Call

- 1 Enter the number with the keypad keys (up to 40 digits).

Note: If you make a mistake, press **DELETE** () to delete the last digit, or press and hold **DELETE** () to clear all digits.

- 2 Press  (send key) to make the call.
- 3 Press  (end key) when the call is done.

Note: You can make an emergency call even when the phone is locked, or when a SIM card is not inserted. See “Dialing an Emergency Number” on page 44.



Answering a Call

To answer a call, your phone must:

- be turned on and unlocked
- have a SIM card inserted and unlocked
- have a network connection with adequate signal strength

When you receive a call, your phone rings and/or vibrates and displays an incoming call message.

To Answer a Call

- 1 Press  or **ANSWER** () .
- 2 Press  (end key) when the call is done.





Using Your Phone





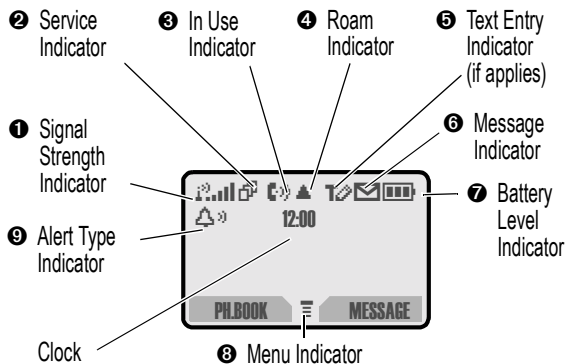

See page 1 for a diagram of basic phone components.

Display Symbols

Some of the phone functions described in this guide must be performed from the idle display. The term *idle display* refers to the standard display that you see when your phone is on and ready to use, when you are *not* on a call or using the menu system.



1 Signal Strength Indicator Shows the strength of your phone's connection with the network.

Strong       No signal

You cannot make or answer calls when the "no signal" indicator is displayed.



2 Service Indicator Indicates if you have a GPRS connection (📶). GPRS allows faster data transfer speeds, and your service provider may indicate when a GPRS packet data connection is active. The indicator does not mean that you are in a call; only that you are registered on the network via a GPRS connection.

3 In Use Indicator Indicates when a call is in progress, and when you have a secure (🔒) or unsecure (🔓) connection.



4 Roam Indicator Appears when your phone uses another network system outside your home network. When you leave your home network area, your phone *roams* or seeks another network. Icons here can also indicate your text entry mode (alpha, numeric, symbol, etc.)

5 Text Entry Indicator Indicates your Text Entry Method whenever you are in a text editor (Tap, iTap, etc.). See “Entering Text” on page 40.



6 Message Indicator Indicates when you have an active Chat session, or when you have a new voice or text message waiting.

7 Battery Level Indicator Shows the amount of charge left in your battery. The more bars visible, the greater the charge.

High



Low

Recharge your battery as soon as possible when you see the **Low Battery** warning message and hear the low battery alert.



Note: When you charge the phone, the battery level indicator instead shows how much of the charging process is complete. See “Charging the Phone” on page 28.

☰ Menu Indicator Indicates that you can press ☰ to open a menu. See “Using the Menu” on page 35.

🔔 Alert Type Indicator Shows the current selected alert profile. The default alert setting is loud ring.

 Loud ring

 Soft ring

 Vibrate

 Vibrate and ring

 Silent

Using the Menu

Navigating to a Feature

This guide shows how to navigate to a menu feature as follows:

Find the Feature



> **Recent Calls**

> **Dialled Calls**

The > symbol means that you should scroll to and select the feature. This example shows that you should press ☰, scroll to and select **Recent Calls**, then scroll to and select **Dialled Calls** to see the dialled calls list.



Selecting a Feature

Some features require you to select an item from a list:

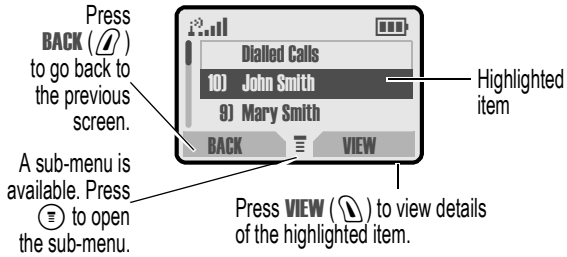

Select an item by highlighting it using one of these approaches:

- Press (⬆️) to scroll up or down to the item you want.
- In a numbered list, press a number key to highlight the item.
- In an alphabetised list, press a key multiple times to cycle through the letters on the key and highlight the closest matching list item.

Setting Up Your Phone

You can adjust a wide variety of phone settings to suit your needs. You can download pictures and sounds to use as your wallpaper, screen saver, animation, or alert tones. See "Downloading Pictures, Games, and Sounds" on page 70.

Setting the Time and Date

Find the Feature

- (☰) > **Settings** > **Other Settings**
> **Initial Setup** > **Time and Date**

Changing Personal Greetings



To change the text displayed when you turn on your phone:

Find the Feature



> **Settings** > **Other Settings**
> **Personalise** > **Greeting**

Choosing Alert and Ring Tones

Your phone rings or vibrates to notify you of an incoming call, message, or other event. This ring or vibration is called an *alert*. You can select one of five different alert profiles:

Loud ring

Soft ring

Vibrate

Vibrate and ring

Silent

The alert setting indicator in your display shows the current alert profile (see illustration on page 33).

Each alert profile contains settings for ring tone and keypad volume. It also includes alert tone settings for different events: incoming calls, text messages, voicemail messages, data calls, alarms, and reminders. You can modify the settings in each profile.

Note: To mix your own alert tones, see “MotoMixer Sound Editor” on page 73.



Select an Alert Profile

Find the Feature  > **Ring Styles** > **Alert** > *profile*

Customise an Alert Profile

You can customise a profile by changing the alerts used for specific events (such as incoming calls, text messages, etc.).

Find the Feature  > **Ring Styles** > **alert Detail**
> *an event* > *event alert*

Note: To create your own alert tones, see “MotoMixer Sound Editor” on page 73.

Setting Your Display Features

You can change the appearance of your display.

Find the Feature  > **Settings** > **Other Settings**
> **Initial Setup**

Choose one of the following display settings:

Setting	Description
Backlight	the amount of time your backlight remains on (Off conserves the battery)
Contrast	the display contrast
Scroll	tells the cursor to stop or wrap around when it reaches the end of a list in the display
Animation	makes your phone's menus move smoothly as you scroll up and down (Off conserves the battery)
Battery Save	Adjusts the phone's power usage to conserve power





Resetting All Options

To reset all options back to their factory settings except for the unlock code, security code, and lifetime timer:

Find the Feature



> **Settings** > **Other Settings**
> **Initial Setup** > **Master Reset**

Clearing All Information

To reset all options back to their factory settings *and* clear all user entries (such as Phonebook entries and downloaded wallpapers, screen savers, and sounds):

Warning: This option erases all user-entered information stored in your phone's memory, including phonebook and datebook entries and downloaded files. Once you erase the information, it cannot be recovered. It resets all options back to their factory settings except for the unlock code, security code, and lifetime timer.

Find the Feature



> **Settings** > **Other Settings**
> **Initial Setup** > **Master Clear**





Setting Other Preferences

To customise other settings on your phone:

- **Calls:** See “Diverting a Call” on page 47 and “Barring a Call” on page 48.
- **Menus:** See “Customising Menus and Display” on page 57 and “Using MyMenu” on page 58.
- **Pictures and Sounds:** See “Customising Menus and Display” on page 57, “Downloading Pictures, Games, and Sounds” on page 70, “Creating Alert Tones” on page 73, “MotoMixer Sound Editor” on page 73, and “Assigning Phone Themes” on page 71.

Entering Text



Various text entry methods make it easy for you to enter names, numbers, and text messages on your phone.

Character Chart

Use this chart as a guide for entering spaces, numbers, letters, symbols, and other characters with the **Tap Method** text mode. Press the same key repeatedly to cycle through available characters.

1 [space]	space . 1 ? ! , @ _ & ~ : ; "
2 [abc]	- () ' ÿ j % £ \$ ¥ ¤ €
3 [def]	a b c 2 ä å á à â ã α β ç
4 [ghi]	d e f 3 δ ë é è ê φ
5 [jkl]	g h i 4 ï í î γ
5 [jkl]	j k l 5 λ

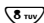

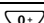
 6 mmo	m n o 6 ñ ö ø ó ò ô õ ω
 7 pps	p q r s 7 π β σ
 8 tuv	t u v 8 θ ü ú ù û
 9 wxyz	w x y z 9 ξ ψ
 0 +	+ - 0 x * / \ [] = > < # §

Your phone model may not include all of the characters shown in the above chart.

Choosing a Text Mode

To activate a text mode, press  > **Entry Method** from any text entry screen and select the text mode:

- iTAP** Let the phone predict each word as you enter it, then choose the word from a list (see “Predictive Text Entry with iTAP™ Software” on page 42).
- Tap Method** Enter characters one at a time by pressing the key for the letter, number, or symbol. This is the standard mode for entering text on your phone.
- Numeric** Enter numbers only.
- Symbol** Enter symbols only.
- Browse** Browse through your phonebook and recent calls lists to select a name or number to enter.

Note: The text mode you select remains active until you change it by selecting another mode.



General Text Entry Rules

- If you do not press a key for two seconds, the character in the block cursor is accepted, and the cursor moves to the next position.
- The first character of each sentence is capitalised unless you manually change it. (Press up or down to change the character to upper or lower case while it is highlighted.)

Predictive Text Entry with iTAP™ Software

iTAP™ software provides a predictive text entry method that lets you enter the letters of a word using only one keypress per letter.

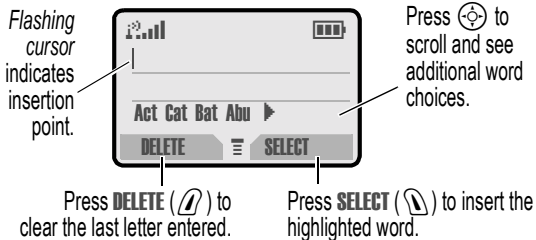

For example, to spell “act,” press :



Calling Features

This chapter describes features related to making and answering calls. For information about other call-related features, see “Viewing Recent Calls” on page 45 and “Data and Fax Calls” on page 61. For basic instructions on how to make and answer calls, see pages 30-31.

Redialing a Number

You can redial a previously dialed phone number, whether the call was connected or busy. From the idle display, press , select the call you want to redial, and press  again.

Using Caller ID



The *calling line identification* (caller ID) feature lets you see who is calling before you answer.

- If the caller's name is stored in your phonebook, the phone automatically displays the **Name** or **Icon ID**. Otherwise, the phone displays the caller's phone number. To create or change a phonebook entry, see “Storing a Phonebook Entry” on page 54.
- If caller ID information is not available, your phone displays the message **Incoming Call**.
- **Outgoing Calls:** Other phones can display your phone number when you call them or send a message. To hide your number for the next call or message, press  > **Settings** > **In-Call Setup** > **My Caller ID** > **Next Call Only**.

Dialing an Emergency Number

Your service provider programs one or more emergency phone numbers (such as 999) that you can call under any circumstances. You can dial and call the emergency number even when your phone is locked, when you are prompted to enter a code or password, when the SIM card is not inserted in your phone, or when the SIM card is blocked or disabled.

Note: Emergency numbers vary by country. Your phone's emergency number(s) may not work in all locations.

To call the emergency number at any time:

Press	To
1 keypad keys	dial the emergency number (such as 999).
2 	call the emergency number.

Inserting Special Characters into Dialing Sequences

While dialing (with digits visible in the display), you can press  and insert one of the following:

Option	Description
Insert Pause (inserts a p)	Your phone waits until the call connects before it dials the next digit(s) in the series.

Option	Description
Insert Wait (inserts a w)	Your phone waits until the call connects, then prompts you for confirmation before it dials the next digit(s).
Insert 'n' (inserts an n)	Your phone prompts you for a number before dialing the call. The number you enter is inserted into the dialing sequence in place of the n.

Viewing Recent Calls

You can view and call numbers from calls you recently dialed or received:

Find the Feature



> **Recent Calls** > **Received Calls**
or
Dialed Calls

Using Voicemail



You can listen to your voicemail messages by calling your network voicemail phone number. Voicemail messages are stored on the network - not on your phone. Contact your service provider for more details.



Storing Your Voicemail Number

Store your voicemail number in your phone to make it faster and easier to use voicemail. Your voicemail number is provided by your service provider.

Find the Feature



> Messages



> VoiceMail Setup

Listening to a Voicemail Message



Once you store your voicemail number, you can listen to your voicemail messages at any time:

Find the Feature

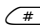

> Messages > VoiceMail

Speed Dialing

When you store an entry in your phonebook, it is assigned a unique speed dial number. You can then use the speed dial feature to call the entry. In the idle display, just enter the speed dial number and press  .

One-Touch Dialing

You can call phonebook entries 1 to 9 with the push of a single key. Press and hold the one-digit speed dial number for one second. You must assign the 1-touch dial feature to numbers 1 to 9 in your phone memory phonebook or SIM card phonebook:

Find the Feature



> Settings > Other Settings

> Initial Setup

> 1-Touch Dial

Note: Your service provider may assign entry 1 to your voicemail number.



Using Call Waiting



If you subscribe to call waiting, an alert tone sounds while you are on a call to indicate that you have received a second call. To put the first call on hold and answer the second call, press **[3]**. To activate or deactivate call waiting:

Find the Feature  > **Settings** > **In-Call Setup** > **Call Waiting**

Diverting a Call



Call diverting sends your phone's incoming calls directly to another phone number.

Find the Feature  > **Settings** > **Call Forward**



The call diverting options are:

Setting	Description
All Calls	diverts all calls.
If Unavailable	diverts calls if your phone is unavailable.
Detailed	uses different diverting numbers if you are out of range, unable to answer, or busy (<i>voice calls only</i>).
Off	does not divert calls.



Linking Calls



To talk to more than one person on a call, you can make a conference call. Call the first person and press **HOLD** () , then call the second person and press **LINK** () .

Transferring a Call

You can directly transfer a call without talking to the person who answers. During a call:

Find the Feature  > **Transfer**

Enter the phone number where you are transferring the call and press .

Barring a Call





Call barring lets you restrict outgoing or incoming calls. You can restrict all calls, calls to international numbers, or calls while roaming, or all calls but home.

Find the Feature  > **Settings > Security**
> **Call Barring**

Putting a Call on Hold

While you are on a call:

Press	To
HOLD () (if available)	put a call on hold.
or	
 > Hold	Your phone displays a  (flashing phone) indicator to indicate that the call is on hold.



Messages



Text messages are brief messages that you can send and receive (such as **Where are we meeting?**). Received messages appear on your phone display or in your text message inbox.

You must set up the text message inbox *before* you can send and receive these messages. Contact your service provider for details.

Note: Your service provider may have already programmed the text message inbox settings for you.

Sending Messages, Pictures, and Sounds

You can send text messages and pictures or sounds to one or more recipients. You can manually enter each recipient's phone number, or select one or more numbers from the phonebook or recent calls lists.

Note: Files may not be compatible with some brands of handsets.

When you manually enter multiple phone numbers in the **To** field, you must insert a space between each number. Press and hold  to insert a space as needed.

Find the Feature





> **Messages**



> **Create Message**

Complete the message contents:

Item	Description
To	Enter one or more phone numbers or email addresses where you want to send the message. You can press BROWSE () to select recipients from the phonebook or recent calls lists.
Msg	Enter the text message (see "Entering Text" on page 40). To insert a picture, animation, or sound file in the message, press:  > Insert > <i>object type</i> > <i>object</i>

Viewing Message Status

Text messages that you send are stored in the outbox. To view the contents of your outbox:

Find the Feature

 > **Messages** > **Outbox**



Messages are sorted from newest to oldest. The following icons indicate message status:

» = sending in progress

 = delivered

✕ = sending failed

Receiving and Reading Messages

When you receive a new message, your phone displays **New Message**  and gives an alert. Press **READ** () to open the message (or your text message inbox if there are multiple messages).

Note: When your inbox is full, a flashing envelope icon appears. New messages will not appear until you delete some of the ones you have.

While reading a message, you can press  to view the **Text Msg Menu** that includes the following options:

Option	Description
Call Back	Call the number in the message header or embedded in the message.
Reply	Open a new text message, with the sender's Reply To number or email address in the To field.
Forward	Open a copy of the text message, with an empty To field.
Chat	Open a chat session with the message sender.
Lock	Lock the message so that cleanup does not delete it.
Store	Store a message attachment (picture, animation, or sound file) or a phone number in the message. You can also save some attachments as your Wallpaper , Screen Saver , or Ring Tone .
Delete	Delete the message.



Option	Description
Delete All	Delete all inbox messages.
New Message	Open a new text message.
Setup	Open the text message inbox setup menu.



Phonebook

You can store a list of names and phone numbers or email addresses in your phone's electronic phonebook. You can view these entries and call them directly from your phone.

To see the list of names stored in your phonebook, press **☰** > **Phonebook** from the idle display. Scroll to a name and press **VIEW** (**⏏**) to view details of the phonebook entry as shown in the following display.

Items in a Phonebook Entry

Type indicator identifies number type:

-  Work
-  Home
-  Main
-  Mobile
-  Fax
-  Pager
-  Email

Voice Name indicator indicates a recorded voice name

Entry's Name

Entry's phone number, email address, or mailing list members.

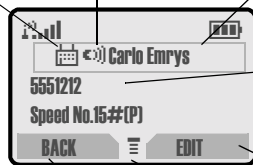

Edit entry

Return to list

Press **☰** to open the Phonebook Menu

Notes:

- **Email Address** entries, **Mailing List** entries, and entries stored on the SIM card do not have **Type**, **Voice Name**, **Icon ID**, or **Ringer ID** information.
- If the phonebook entry is a mailing list, list members are listed after the entry's name

Storing a Phonebook Entry



For email addresses, you can send a text message directly from your phone.

Find the Feature

- > **Phonebook**
- > **New**
- > **Phone Number** or
Email Address or
Mailing List

Phonebook item	Description
Name	a name for the phonebook entry (see "Entering Text" on page 40).
No., Email, or Members	the phone number or email address, or select phonebook entries to add as members of the mailing list.
Type	the type of phone number (only for phone numbers not stored on the SIM).
Voice Name	record a voice name for the entry. Press and release RECORD () , then say the entry's name (in two seconds).

Phonebook item	Description
Speed No.	the number you use to <i>speed dial</i> the entry. Entries with a speed dial number from 1 to 100 are stored on the phone. Entries with a speed dial number of 101 or higher are stored on the SIM card.
Icon ID	the icon that should appear when you receive calls or messages from this entry.
Ringer ID	the alert your phone should use when you receive calls or messages from this entry.
More	create another entry with the same Name .

Dialing a Phonebook Entry

You can use the phonebook list, voice dial, speed dial, or 1-touch dial to call a number stored in your phonebook. To use speed dial, see “Speed Dialing” on page 46. To use 1-touch dial, see “One-Touch Dialing” on page 46.

Phonebook List

Find the Feature



> Phonebook

Select the entry and press .

Shortcut: In idle, press up or down to open the Phonebook.



Voice Dial

Find the Feature  > **Voice Dial**

Say the pre-recorded phonebook entry name.

Editing a Phonebook Entry

You can edit a phonebook entry stored on your phone or the SIM card. If you change an entry's speed dial number, the entry is moved to the new speed dial location and the original entry is deleted.

Note: You can also use the following procedure to edit a fixed dial entry by scrolling to and selecting **Fix Dial**.

Find the Feature  > **Phonebook**

Select the entry and press  > **Edit** or **Delete**.

For a description of the items in a phonebook entry or fixed dial entry, see "Items in a Phonebook Entry" on page 53 and "Storing a Phonebook Entry" on page 54.



Customising Your Phone Settings



You can adjust your phone's menus and features.

Customising Menus and Display

Find the Feature

 > **Settings** > **Other Settings**
> **Personalise**

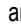

You can change settings for these features:

Setting	Description
Main Menu	change the order of the items in your phone's main menu.
Keys	change the features linked to your (left  and right ) in the idle display.
Greeting	change the text displayed when you turn on your phone.
Wallpaper	select your display's background image and layout.
Screen Saver	select an image to appear when your phone is idle, and the amount of delay.
Quick Dial	change the numbers stored under  > Quick Dial .

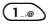

Using MyMenu

MyMenu lets you quickly access your favorite menu features.

You can use MyMenu from the idle display, while on a call, or while scrolling through a menu. Just press  and then the MyMenu key number ( to  ).

To add a menu item to the MyMenu list, just select the item and hold  until the phone asks you for a confirmation.



Getting More Out of Your Phone

Dialing Options



Fixed Dialing

When you activate the fixed dial feature, users can only call the numbers in the fixed dial list.

Find the Feature



> **Settings** > **Security** > **Fixed Dial**

Fixed dial list entries can be any length. If there is a fixed dial entry for the digits 555, users can call any number that starts with 555. You must enter your SIM PIN2 code, from your network service provider, to edit fixed dial entries.

Find the Feature



> **Fixed Dial**

In the fixed dial list, you can create, edit, delete, and sort entries just like in the phonebook list. Fixed dial list entries are stored on your SIM card and do not have **Type** or **Voice Name** fields.

Sending DTMF Tones

While you are on a call, you can send keypresses as tones by pressing



> **Send Tones**.

To set DTMF tones to be long, short, or off:

Find the Feature



> **Settings** > **Other Settings**
> **Initial Setup** > **DTMF**

Monitoring Phone Use

Network connection time is the elapsed time from the moment you connect to your service provider's network to the moment you end the call by pressing . This time includes busy signals and ringing.

The amount of network connection time you track on your resettable timer may not equal the amount of time for which you are billed by your service provider. For billing information, please contact your service provider directly.

To view a call timer:

Find the Feature



> Recent Calls > Call Times

You can view the approximate network connection time elapsed during the following calls:

Timer	Description
Last Call	Time spent on the last call dialed or received. You cannot reset this timer.
Dialled Calls	Total time spent on dialled calls since the last time you reset this timer.
Received Calls	Total time spent on calls received since the last time you reset this timer.
All Calls	Total time spent on dialled and received calls since the last time you reset this timer.
Lifetime	Total time spent on all calls on this phone. You cannot reset this timer.

Network Features

Data and Fax Calls



A Motorola Original™ data kit lets you transfer data between your phone and a computer or other external device. You can:

- use your phone to make and answer data and fax calls on your computer or hand-held device.
- use your phone as a modem to connect to the Internet

Note: 56K modems are capable of receiving 56Kbps from a compatible service provider. Receiving is currently limited in the U.S. and Canada to 53 Kbps, and transmitting to 33.6 Kbps. Actual speeds will vary depending on line conditions.

Connecting Your Phone to an External Device

Connect your phone to an external device (such as a computer or hand-held device) using a USB cable.

Note: Not all devices are compatible with USB cable connections. Check your external device for specifications.

Attach the cable and do the following:

To Establish a Connection

- 1 Check the phone make sure that the phone is connected and powered on.



To Establish a Connection

- 2 Open the application on your computer place the call through the application (such as dial-up-networking)
Note: You cannot dial data or fax numbers through your phone's keypad. You must dial them through your computer.
- 3 End the transfer on your computer close the call and connection when the transfer is complete.

Network Selection

You can view and adjust your phone's network settings:

Find the Feature



> **Settings** > **Other Settings**
> **Network**

Your service provider registers your phone to a network. You can view information about the current network, change how your phone searches for a network, specify your preferred networks, and activate alerts that indicate when a call is dropped or network registration changes.



Security

Line Security

If your phone displays **Line Not Secure** while you are on a call, your phone has detected another device monitoring the call. This message does not appear when caller ID, call cost, or other information fills the display.

Locking and Unlocking Your Phone

A locked phone still rings or vibrates for incoming calls or messages, *but you must unlock it to answer.*

Lock Your Phone Manually

Find the Feature



> **Settings** > **Security** > **Phone Lock**
> **Lock Now**

Set Your Phone to Lock Automatically

You can set your phone to lock every time you turn it off:

Find the Feature



> **Settings** > **Security** > **Phone Lock**
> **Automatic Lock** > **On**



Changing Your Unlock Code

Your phone's four-digit unlock code is originally set to 1234, and the six-digit security code is originally set to 000000. Your service provider may reset these numbers before you receive your phone.

If your service provider has *not* reset these numbers, we recommend that you change them to prevent other users from accessing your personal information or modifying your phone settings. The unlock code must contain four digits, and the security code must contain six digits. Be sure to make a note of the new numbers.

Find the Feature



> **Settings** > **Security** > **New Passwords**
> *the password*

If You Forget a Code or Password

If you forget your unlock code, try entering 1234 or the last four digits of your phone number. If that does not work, press  and enter your security code when you see the **Enter Unlock Code** message. See your service provider if you do not know your security code.

Protecting the SIM Card

When the SIM PIN feature is activated, you must enter your SIM card PIN code each time you turn on the phone or insert a SIM card.

Find the Feature



> **Settings** > **Security** > **SIM PIN**
> **On or Off**



Unlock the SIM Card PIN Code

If you enter an incorrect SIM card PIN code three times in a row, your SIM card is disabled and your phone displays the message **SIM Blocked**. You need to enter a PIN unblocking key (PUK) code, which you can obtain from your service provider.

Caution: If the unblocking attempt is tried unsuccessfully 10 times, the SIM card is permanently disabled and your phone displays the message **SIM Disabled**.

Protecting Web Transactions



The WAP Identity Module (WIM) contains information for e-commerce and other Internet security.

If WIM security is **On**, your phone prompts you for your WIM PIN whenever you turn on your phone or insert a new SIM card. To turn WIM security on or off:

Find the Feature



> **Settings** > **Security** > **WIM PIN**

To change your WIM PIN, see “Changing Your Unlock Code” on page 64.





Personal Organiser Features

Datebook

The datebook is a calendar that lets you schedule and organise events such as appointments and meetings. You can review your schedule of events for the week or by the day, and have the datebook play a reminder alarm for specific events.

Note: You must set the phone's correct time and date in order to use the datebook (see "Setting the Time and Date" on page 36).

Storing a New Event

A title is required for a datebook event. All other information is optional.

Find the Feature



> **Datebook** > *day*



> **New**

Enter the event title, start time, duration, date, repeating events, and reminder.

Changing Event Information

To change information about an existing event:

Find the Feature



> **Datebook** > *event date*

> *event*

Select and change the event information.



Alarm Reminders

Reminders are alerts that ring or vibrate to notify you about a voicemail or text message you have received, or a datebook event you have scheduled. To set or turn off reminders:

Find the Feature

- ☰ > Ring Styles > Alert Detail
- > Reminders > Alert

Note: **Beep** or **Vibrate** sets the corresponding reminder alert type. **Off** turns off all reminders.

Calculator

You can use your phone as a convenient calculator and currency converter.

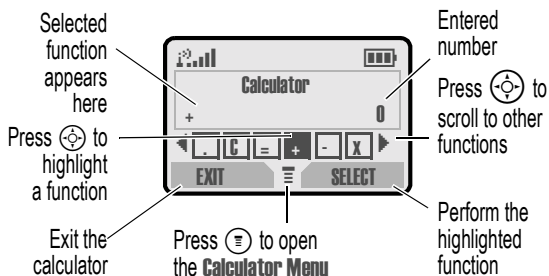

The currency converter works just like the calculator, using the \$ (currency) function and the exchange rate you set:

Find the Feature

- ☰ > Calculator
- ☰ > Exchange Rate

News and Entertainment

Mobile Internet



The Web micro-browser lets you access Web pages and Web-based applications (such as on-line banking, shopping, and games) on your phone. Contact your service provider to set up access, if necessary.

Setting Up Your Phone for Mobile Internet Access

Note: Your service provider may have set up your phone for Internet access.

You can adjust the mobile Internet network connection settings, or create a new network connection profile:

Find the Feature  > **Web Sessions** > **[New Entry]**

Starting a Mobile Internet Session



To open the Web micro-browser:

Find the Feature  > **Browser**

If you are unable to establish a network connection with the micro-browser, contact your service provider.

Do This	To
Press  up or down	scroll through a page.



Do This	To
Press  or right	go back to the previous page or forward to the next one.
Press 	open the Browser Menu .

Downloading Pictures, Games, and Sounds

You can download a file such as a ring tone, wallpaper, screensaver, MotoMixer file, game upgrade, or theme to your phone. To download files with the browser on a desktop computer or your phone:

Downloading a File Using a Web Browser

- 1 In the browser, go to the Web site and find the file you want.
- 2 Follow the directions on the site to purchase the file (payment details vary). The site sends a text message to your phone, containing the attached file or a URL link to the file.
- 3 Open the message and store the file (see “Receiving and Reading Messages” on page 51).

Notes:

- Call charges apply during download sessions.
- When your phone runs out of memory for downloaded files, new files overwrite the old ones. Downloaded files share your phone’s memory, so you can make room for a picture, for example, by deleting ring tones.





Assigning Phone Themes

In addition to downloading an individual screen saver, wallpaper, or ring tones, you can download all three in a bundle, with a theme such as a special event or a cartoon character.

To download a theme, see “Downloading Pictures, Games, and Sounds” on page 70. When you receive the theme, you can instantly apply its screen saver, wallpaper, and ring tone when your phone prompts you to **Apply Now?**

Your phone saves the downloaded files so that you can always apply them as individual items as described in “Setting Up Your Phone” on page 36.

Games

Your phone comes with three games. If you get an incoming call, message, alarm, or alert while playing a game, the game pauses.

Find the Feature  > **Games** > *the game*

When the game is over, you can purchase more advanced game levels, play another session of the same game, or return to the games menu.

Astrosmash

In Astrosmash, your job as Commander is to repel an attack of meteors and spinning bombs. You try to shoot as many meteors, bombs, missiles, and flying saucers as possible without getting hit. Use  to direct your ship. Firing is automatic.





Level One: 1500 point limit

Item	Points	Item	Points
Big Rock	10	Guided Missile	50
Small Rock	20	Small Spinner	80
Big Spinner	40		

Game upgrades remove point limits and add UFOs (100 points) and Hyperspace.

MotoGP

In this game, you are a MotoGP motorcycle racer. Use  to accelerate, brake, and turn your motorcycle.

Level One: "Quick Race", with one lap and one racer.

Game upgrades include other racers and tracks, with "Time Attack" (a time trial with yourself only), and "Grand Prix" (a series of 3 races with other competitors). You can choose a team and a track.

Snood 21

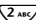
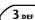
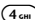
In this solitaire game, you try to use all the cards in a deck by making combinations of 21 on any of four columns. When a combination of 21 is created, the cards are discarded, letting you start another combination of 21. Use    and  to place cards on columns one to four.

Level One: 32 cards, with a one-minute time limit.

If you finish the first level in one minute, you can move on to the next one. Game upgrades allow more time.



MotoMixer Sound Editor

The MotoMixer lets you edit and save special MIDI-based sound files in your phone. These sound files include one or more “base tracks”, plus extra tracks such as “DRUM”, “BASS”, and “SOLO”. To create or edit a MotoMixer file:

Find the Feature



> **Media Center** > **MotoMixer**
> **[New Mix]**
or a tune to edit

Select and name the tracks you want in the Mix. Turn instruments on or off, add effects or pick an instrument variant using your phone's keypad.

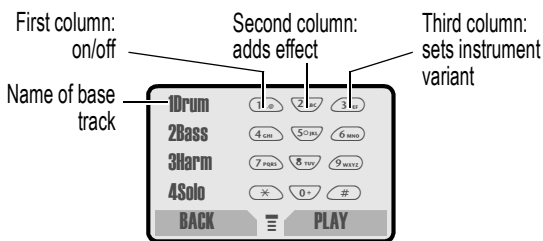

Note: To download new MotoMixer files, see “Downloading Pictures, Games, and Sounds” on page 70.

Creating Alert Tones



The **My Tones** feature lets you create up to 32 custom alert tones, which appear in the list of available alerts (see “Choosing Alert and Ring Tones” on page 37).

Find the Feature

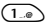
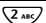
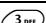
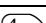

> **Ring Styles** > **My Tones**
> **[New Tone]**

To create a new tone, use the keypad keys to enter each note. Press a key multiple times to cycle through its available notes or options (pitch, octave, or length).

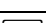
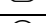
Key	Displays	Description
	1, 2, 3	set octave one, two, or three
	A, B, C, 2	note A, B, C, or set octave 2
	D, E, F, 3	note D, E, F, or set octave 3
	G, R	note G or rest
	#, b	sharp or flat
	q, h, w	quarter, half, whole note/rest
		move cursor left or right

SIM Applications



You can access information and applications stored on your SIM card.

To access the available applications:

Find the Feature









> **SIM Applications**

Note: To download new applications, see “Downloading Pictures, Games, and Sounds” on page 70.

Troubleshooting

Check these questions first if you have problems with your phone:

Question	Answer
Is your battery charged? Do you see  in the display?	The battery level indicator should have at least one segment showing (). If it does not, recharge your battery. (See “Charging the Phone” on page 28 and “Battery Use” on page 29.)
Do you have a valid SIM card inserted in your phone?	If necessary, turn off your phone and make sure that you have inserted a valid SIM card. (See “Changing Your SIM Card” on page 22).
Does the handset have a signal? Do you see  in the display?	The signal strength indicator should have at least one segment showing (). If it does not, move to an area with a stronger signal to use your phone.
Is the earpiece volume too low?	While on a call, press right on the  key.
Is the other party unable to hear you?	Your phone may be muted. Press UNMUTE () if necessary to unmute the phone. Also, make sure that your phone’s microphone is not blocked by its carrying case or a sticker.



Question	Answer
Has the phone been damaged, dropped, or gotten wet?	Dropping your phone, getting it wet, or using a non-Motorola battery charger can damage the phone. The phone's limited warranty does not cover liquid damage or damage caused from using non-Motorola accessories.
Was a non-Motorola battery charger used?	



Specific Absorption Rate Data

This model phone meets international standards for exposure to radio waves

Your mobile phone is a radio transmitter and receiver.

It is designed and manufactured not to exceed limits for exposure to radio frequency (RF) energy.

These limits are part of comprehensive guidelines and establish permitted levels of RF energy for the general population.

The guidelines are based on standards that were developed by independent scientific organizations through periodic and thorough evaluation of scientific studies.

The guidelines include a substantial safety margin designed to assure the safety of all persons, regardless of age and health.

The exposure standard for mobile phones employs a unit of measurement known as the Specific Absorption Rate, or SAR.

Under the guidelines for your phone model, the SAR limit is 2.0 W/kg.*

Tests for SAR are conducted in accordance with CENELEC** testing procedures using standard operating positions with the phone transmitting at its highest certified power level in all tested frequency bands.

Although the SAR is determined at the highest certified power level, the actual SAR of the phone while operating can be well below the maximum value.

This is because the phone is designed to operate at multiple power levels so as to use only the power required to reach the network.





In general, the closer you are to a base station, the lower the power output of the phone.

Before a phone model is available for sale to the public, it is tested to confirm compliance with the guidelines.

The tests are performed in positions and locations (e.g., at the ear and worn on the body) that conform to a uniform testing methodology determined by an expert standards body.

The highest SAR value for this model phone when tested for use at the ear is: 0.55 W/kg.***

While there may be differences between the SAR levels of various phones and at various positions, they all meet the governmental requirements for safe exposure.

Please note that modifications to this product model could cause differences in the SAR value for later products; in all cases, products are designed to be within the guidelines.

* The SAR limit recommended by international guidelines (ICNIRP) for mobile phones used by the public is 2.0 watts/kilogram (W/kg) averaged over ten grams of tissue. The limit incorporates a substantial margin for safety to give additional protection for the public and to account for any variations in measurements.

** CENELEC is a European Union standards body.

*** Additional related information includes the Motorola testing protocol, assessment procedure, and measurement uncertainty range for this product.



Index

A

- accessories
 - connector ports 1
 - optional 21, 61
 - standard 21
- alert
 - creating 73
 - defined 37
 - indicators 35, 37
 - reminders 68
 - type, selecting 38

- alert profile 38
- animation 70
- Astrosmash 71

B

- backlight 38
- barring calls 48
- battery
 - charging 28
 - extending battery life 29, 38
 - level indicator 28, 33, 34
- browse text mode 41
- browser. *See* micro-browser

C

- calculator 68
- call
 - alert profile, setting 38
 - alert type, selecting 38
 - alert, creating 73
 - answering 31
 - barring 48
 - call waiting 47
 - dialing 30-31
 - emergency number 44
 - ending 31
 - hold 48
 - making 30-31
 - placing 30-31
 - receiving 31
 - timing 60
 - transferring 48
- call barring 48
- call diverting 47
- call timers 60
- call waiting 47
- caller ID
 - incoming calls 43
- calling line identification.
See caller ID



clock 33
codes. See passwords
computer
 connecting to phone 61
conference call 48
contrast, display 38
D
data call
 connecting to external
 device 61
 making 62
date, setting 36
datebook
 adding an event 67
 changing event
 information 67
 reminders 68
default passwords 64
dialing a number 30-31
display
 backlight 38
 contrast 38
 described 33-35
 frozen 27
 greeting 37
 idle display 33
 illustration 33
 resetting 27
diverting calls 47
DTMF tones 59

E
earpiece
 illustration 1
 volume, adjusting 30
emergency number 44
end key
 functions 1, 29, 31
ending a call 31
Enter Unlock Code message 64
event alert 38
external device
 connecting to phone 61
F
factory settings, resetting 39
fax call
 connecting to external
 device 61
fixed dial
 defined 59
 dialing numbers 59
 editing an entry 56, 59
 storing an entry 54
frequency, changing 62
G
games 71
greeting, display 37
H
hold a call 48

I

- icon ID 55
- idle display, defined 33
- Incoming Call** message 43
- indicators
 - alert setting 35, 37
 - battery level 28, 33, 34
 - menu 33, 35
 - message 34
 - message waiting 33
 - ring alert 35, 37
 - roam 33, 34
 - service 33
 - signal strength 33
 - silent alert 35, 37
 - text entry 34
 - transmit 34
 - vibrate alert 35, 37
 - voice name 53

K

- key
 - end 1, 29, 31
 - left soft key 1
 - menu 1
 - navigation 1
 - right soft key 1
 - send 1, 31
 - volume control 30

L

- left soft key
 - functions 1
- lock
 - phone 63
 - SIM card 64
- loud ring alert 35, 37

M

- making a call 30-31
- making a call.
 - See making a call
- master clear 39
- master reset 39
- menu
 - Browser Menu** 70
 - entering text 40
 - features 59
 - lists 36
 - MyMenu 58
 - navigating 35
 - Phonebook Menu** 53
 - scroll feature 38
- menu indicator
 - defined 35
 - illustration 33
- menu key 1

message
 outbox 50
 receiving 51
 reminders,
 text message 68
 reminders, voicemail 68
 sending 49
 status 50
 voicemail 45-46

message indicator
 defined 34
message waiting indicator
 illustration 33

micro-browser
 animation 70
 Browser Menu 70
 defined 69
 functions 69
 go back to previous
 page 70
 picture 70
 sound 70
 starting 69

microphone 1
mindblaster 71
moto GP 72
my tones 73
N
navigation key 1
network settings 62
numeric text mode 41

82 - Index

O

1-touch dial
 defined 46
 setting preference 46
 using 46
optional accessory, defined 21
optional feature, defined 21
outbox 50

P

passwords
 changing 64
 default 64
 if you forget
 a password 64

phone

 accessories, optional 21
 accessories, standard 21
 connecting to external
 device 61
 date, setting 36
 erase user-entered
 information 39
 frequency, changing 62
 locking 63
 network settings 62
 1-touch dial 46
 passwords 64
 reset all options 39
 speed dial, using 46
 startup greeting 37
 text entry indicator 34



- time, setting 36
- unlock code 64
- unlocking 30, 63
- phone number
 - redialing 43
 - storing in phonebook 54
- phonebook
 - dialing a number 55
 - editing an entry 56
 - email address 53
 - entry name 53
 - fields 53
 - icon ID 55
 - number type indicator 53
 - 1-touch dial 46
 - phone number 53
 - speed dial number 46, 55
 - speed dial, using 46
 - storing an entry 54
 - voice name indicator 53
- Phonebook Menu** 53
- picture
 - storing 70
- PIN code
 - activating/deactivating 64
 - protecting the SIM card 64
 - unlocking 65
- PIN2 code 59
- profile
 - customising 38
 - setting 38
- PUK code 65
- R**
- receiving a call 31
- redial
 - busy number 43
- reminders
 - setting 68
 - text message 68
 - voicemail message 68
- resetting display 27
- right soft key
 - functions 1
- ring alert
 - creating 73
 - indicators 35, 37
 - setting 38
 - type, selecting 38
 - volume, adjusting 30
- ring and vibrate alert
 - indicator 35, 37
- roam indicator
 - defined 34
 - illustration 33

S

scroll feature 38
send key 1, 31
service indicator
 illustration 33
short message service.
See text message
signal strength indicator
 defined 33
 illustration 33
silent alert indicator 35, 37
SIM applications 74
SIM Blocked message 29, 65
SIM card
 applications 74
 defined 22
 precautions 22
 protecting 64
 SIM Blocked message 29, 65
 SIM Disabled message 65
 unblocking 65
SIM Disabled message 65
SIM PIN code
 activating/deactivating 64
 protecting the SIM card 64
 unblocking 65
SIM PIN2 code 59
SMS. See text message
snood 21 72
soft keys
 illustration 1

soft ring alert 35, 37
sound
 storing 70
speed dial
 changing number 55
 number, defined 46
 using 46

T

text
 browse mode 41
 character chart 40
 entering from keypad 40
 entry mode, changing 41
 iTAP software predictive
 text entry 42
 numeric mode 41
text entry indicator
 defined 34
text message
 receiving 51
 reminders 68
 sending 49
 status 50
text mode, changing 41
Text Msg Menu
 options 51
themes 71
time, setting 36
timers 60
transfer a call 48



transmit indicator
 defined 34
travel charger, using 28

U

unlocking the SIM card 65
unlock code 63, 64

V

vibrate alert
 indicator 35, 37
 setting 38
 type, selecting 38

voice dial
 dialing a number 56



voice name
 phonebook indicator 53

voicemail 45-46

volume
 earpiece 30
 ring 30

W

Web pages 69





6809451A97

