

* Some of the contents in this manual may differ from your phone depending on the software of the phone or your service provider.



DUAL BAND GSM TELEPHONE SGH-A408



World Wide Web
<http://www.samsungmobile.com>

Printed in Korea
Code No.: GH68-02508A
English. 11/2001. Rev. 1.0

Contents

Quick Safety Guide	7
Unpacking	9
Your Phone	10
Phone Layout	10
Display	13
Service Light	15
Getting Started	16
Installing the SIM Card	16
Charging a Battery	18
Switching the Phone On/Off	22
General Functions	24
Making a Call	24
Adjusting the Volume	26
Answering a Call	27
Viewing Missed Calls	28
Selecting Functions and Options	30
Example: Setting the Display Language	32
Phonebook	34
Storing a Phone Number with a Name	34
Speed-Dialling by Memory Location	35
Searching for and Dialling a Number in the Phonebook	36
Phonebook Options	37
Entering Text	41
Changing the Text Input Mode	42
Chinese Pinyin Mode	44
Chinese Stroke Mode	49
Quick English Mode	54
English Mode	56
Number Mode	58
Symbolic Mode	58
Using Help	58

In-Call Options	59
Putting a Call on Hold	59
Switching the Microphone Off (Mute)	60
Muting/Sending Key Tones	61
Searching for a Number in the Phonebook	62
Using the SMS Service	63
Answering a Second Call.....	63
Making a Multiparty Call.....	64
Using the Menus	66
Accessing a Menu Function by scrolling	66
Accessing a Menu Function by its shortcut	67
List of Menu Functions	68
Call Records	73
Missed Calls (<i>Menu 1.1</i>).....	73
Received Calls (<i>Menu 1.2</i>)	73
Dialled Calls (<i>Menu 1.3</i>).....	74
Call Time (<i>Menu 1.4</i>).....	74
Call Cost (<i>Menu 1.5</i>).....	75
Messages	76
Read Messages (<i>Menu 2.1</i>).....	76
Write Messages (<i>Menu 2.2</i>).....	78
Preset Messages (<i>Menu 2.3</i>).....	78
Setup (<i>Menu 2.4</i>).....	79
Broadcast (<i>Menu 2.5</i>)	80
Voice Mail (<i>Menu 2.6</i>).....	82
Sound Settings	83
Ring Tone (<i>Menu 3.1</i>)	83
Melody Composer (<i>Menu 3.2</i>).....	83
Ring Volume (<i>Menu 3.3</i>).....	85
Alert Type (<i>Menu 3.4</i>).....	86
Keypad Tone (<i>Menu 3.5</i>)	86
Message Tone (<i>Menu 3.6</i>).....	87

Sound Settings (continued)	
Error Tone (<i>Menu 3.7</i>)	87
Minute Minder (<i>Menu 3.8</i>)	88
Connect Tone (<i>Menu 3.9</i>).....	88

Phone Settings	89
Screen Saver (<i>Menu 4.1</i>).....	89
Infrared Activate (<i>Menu 4.2</i>).....	90
Greeting Message (<i>Menu 4.3</i>)	91
Own Number (<i>Menu 4.4</i>).....	91
Language (<i>Menu 4.5</i>)	92
Light (<i>Menu 4.6</i>)	92
Auto Redial (<i>Menu 4.7</i>).....	93
Active Flip (<i>Menu 4.8</i>)	93
Anykey Answer (<i>Menu 4.9</i>).....	94
Contrast (<i>Menu 4.0</i>).....	94
Reset Settings (<i>Menu 4.*</i>).....	94

Organiser	95
Calendar (<i>Menu 5.1</i>).....	95
To Do List (<i>Menu 5.2</i>)	97
Time & Date (<i>Menu 5.3</i>)	99
Alarm (<i>Menu 5.4</i>).....	101
Calculator (<i>Menu 5.5</i>).....	102
ShortCut (<i>Menu 5.6</i>).....	103

Security	104
PIN Check (<i>Menu 6.1</i>)	104
Change PIN (<i>Menu 6.2</i>).....	105
Phone Lock (<i>Menu 6.3</i>).....	105
Change Password (<i>Menu 6.4</i>).....	106
SIM Lock (<i>Menu 6.5</i>).....	106
FDN Mode (<i>Menu 6.6</i>).....	107
Change PIN2 (<i>Menu 6.7</i>).....	107

Network Services	108
Call Diverting (<i>Menu 7.1</i>).....	108
Call Barring (<i>Menu 7.2</i>).....	110
Call Waiting (<i>Menu 7.3</i>).....	112
Network Selection (<i>Menu 7.4</i>).....	113
Caller ID (<i>Menu 7.5</i>).....	114
Closed User Group (CUG) (<i>Menu 7.6</i>).....	115
WAP Browser	117
Life	118
Games (<i>Menu 9.1</i>).....	118
Health (<i>Menu 9.2</i>).....	119
Solving Problems	124
Access Codes	127
Health and Safety Information	130
Glossary	145
Quick Reference Card	149

Quick Safety Guide

Read these simple guidelines. Failure to comply with them may be dangerous or illegal. For more detailed safety information, see “Health and Safety Information” on page 130.

Road safety comes first

Do not use a hand-held mobile phone while driving; park the vehicle first.

Switch off when refuelling

Do not use the phone at a refuelling point (service station) or near fuels or chemicals.

Switch off on aircraft

Mobile phones can cause interference. Using them on aircraft is both illegal and dangerous.

Switch off in hospital

Follow any regulations or rules. Switch phone off near medical equipment.

Respect special regulations

Follow any special regulations in force in any area and always switch off your phone whenever it is forbidden to use it, or when it may cause interference or danger (in a hospital for example).

Interference

All wireless phones may be subject to radio interference, which may affect their performance.

Unpacking

Radio frequency exposure information

In August 1996, the Federal Communications Commission (FCC) of the U.S. adopted an updated safety standard for human exposure to radio frequency electromagnetic energy emitted by FCC regulated transmitters. The design of this phone complies with the FCC guidelines and these international standards.

To maintain compliance with FCC RF exposure guidelines, if you wear a handset on your body, use the Samsung-supplied or approved carrying case, holster, or other body-worn accessory.

If you do not use a body-worn accessory, ensure the antenna is at least one inch (2.5 cm) from your body when transmitting. Use of non-approved accessories may violate FCC RF exposure guidelines.

Use sensibly

Use only in the normal position (to ear). Do not touch the antenna unnecessarily when the phone is switched on.

Accessories and batteries

Use only SAMSUNG-approved accessories and batteries.

Use qualified service

Only qualified service personnel must repair equipment.

Your package contains the following items.

Handset



Batteries



Hand Strap



User's Manuals

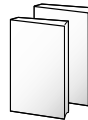

Travel Adapter

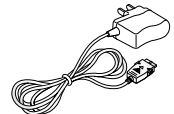

Desktop Charger

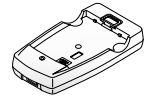

Ear-microphone



In addition, you can obtain the following accessories for your phone from your local SAMSUNG dealer:

- Simple hands-free kit
- Standard and extended batteries
- Cigarette lighter adapter

Your Phone

Phone Layout

The following illustrations show the main elements of your phone.

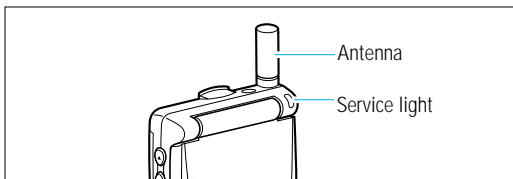

Key Description

 Perform the functions indicated by the text above them (in the bottom line of the display).
(soft keys)



In the menu facility, scroll through the menu options and phonebook memory.

When pressed in idle mode, the ▲ key launches the WAP Browser. The ▼ key accesses your favourite menu options directly (for more information on shortcuts, see page 103).



In the menu facility, return to the previous menu level and select the current menu respectively.

When entering a name, move the cursor left and right respectively.

When pressed in idle mode, access your favourite menu options directly (for more information on shortcuts, see page 103).



Deletes characters from the display.

In the menu facility, returns to the previous menu level.

When held down for more than two seconds in idle mode, accesses one of your favourite menu options directly (for more information on shortcuts, see page 103). It is preset by factory default to enter and exit Silent mode.

Key Description *(continued)*



Makes or answers a call.

In idle mode, recalls the last number dialed.

In the menu facility, selects a menu function or stores information that you have entered (such as a name) in the phone or SIM memory.



Ends a call. Also switches the phone on and off when pressed and held.

In the menu facility, returns to the idle mode and cancels your input.



When held down in idle mode, accesses your voice mailbox.



Enter numbers, letters and some special characters.



Enter special dial characters.



(on the side of the phone)

During a call, adjust the earpiece volume.

In idle mode with the flip cover open, adjust the key volume.

In the menu facility, scroll through the menu options and phonebook memory.

Display

Display Layout

The display comprises three areas.

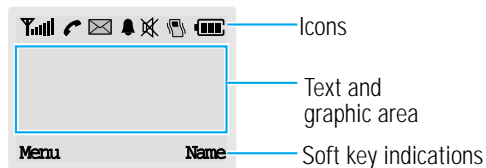

Area Description

First line	Displays various icons (see next page).
Middle lines	Display messages, instructions and any information that you enter (number to be dialled, for example).
Last line	Shows the functions currently assigned to the two soft keys.

Icons

Icon Description *(continued)*

- Shows the received signal strength. The greater the number of bars, the better the signal strength.
- Appears when a call is in progress.
- Appears when a new text message has been received.
- Appears when the Vibrate mode is active.
- Appears when you set the alarm.
- Shows the level of your battery. The more bars you see, the more power you have left.
- Indicates that you have activated the Infrared feature to communicate with an IrDA-compliant device and send or receive data or a fax (for further details, see page 90).
- Appears when you are out of your home area and have registered with a different network (when travelling in other countries, for example).
- Appears when a new voice mail message has been received.
- Appears when you activate the Mute mode.

Backlight

The display is illuminated by a backlight. When you press any key, the backlight illuminates. It turns off if no key is pressed within a given period of time, depending on the **Back Light** option in the **Phone Settings** menu.

To specify the length of time for which the backlight is active, set the **Back Light** menu option (4.6.1); see page 92 for further details.

Service Light

The service light is in the top right-hand corner of the phone. It flashes when services are available on the phone.

To activate or deactivate use of the service light, set the **Service Light** menu option (4.6.2); see page 92 for further details.

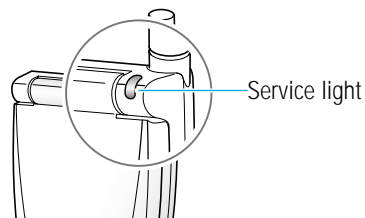

Getting Started

Installing the SIM Card

When you subscribe to a cellular network, you are provided with a plug-in SIM card loaded with your subscription details (PIN, optional services available and so on).

Important! The plug-in SIM card and its contacts can be easily damaged by scratches or bending, so be careful when handling, inserting or removing the card.

Keep all SIM cards out of the reach of small children.

1. If necessary, switch off the phone by holding down the  key until the power-off animation is displayed.
2. Remove the battery. To do so:
 - ① Slide the catch above the battery toward the top of the phone and hold it in the position.
 - ② Lift the battery away, as shown.

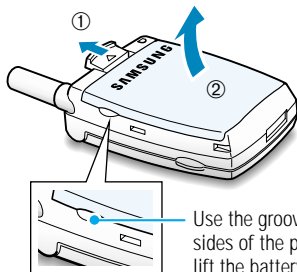

Use the grooves on both sides of the phone when you lift the battery away.

3. Slide the SIM card into the SIM card holder so that the holder locks the card in position.

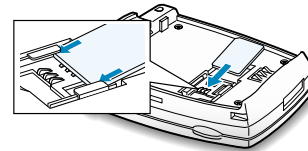

Note: When you need to remove the SIM card, slide it, as shown and take it out of the holder.

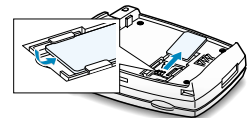

4. Insert the tabs on the battery into the notches on the base of the phone.

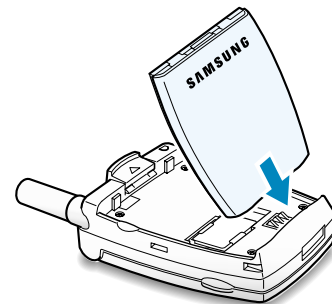

5. Push the battery down until it clicks into place. Make sure that the battery is properly installed before switching on the phone.

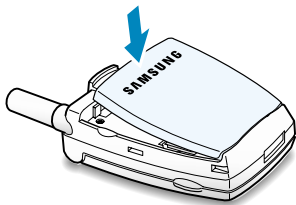

Charging a Battery

Your phone is powered by a rechargeable Li-ion battery. A travel adapter and a desktop charger are provided with your phone. Use only approved batteries and chargers. Ask your local SAMSUNG dealer for further details.

The phone can be used while the battery is charging.

Note: You must fully charge the battery before using your phone for the first time. A discharged battery is fully recharged in approximately 200 minutes.

Charging with the Travel Adapter

Using the travel adapter, you can charge the battery attached to the phone.

1. With the battery in position on the phone, connect the lead from the travel adapter to the bottom of the phone. Check that the arrow on the lead connector is facing towards the front of the phone.

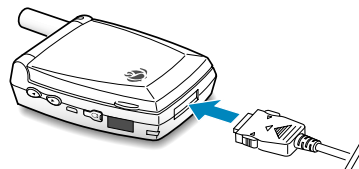

2. Connect the adapter to a standard AC wall outlet.

You can see the bar in the display indicating the charging progress.

3. When charging is finished, disconnect the adapter from the power outlet and from the phone by pressing the gray tabs on both sides of the connector and pulling the connector out.

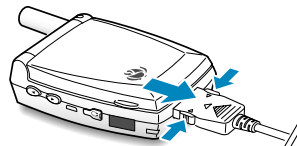

Charging with the Desktop Charger

Using the desktop charger, you can charge the battery alone.

1. Connect the lead from the travel adapter to the connector at the bottom of the charger.

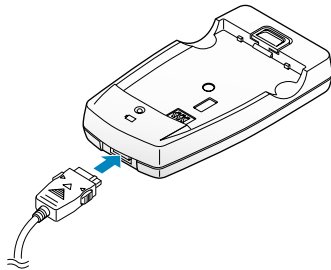

2. Insert the battery alone into the slot of the desktop charger ensuring the terminals on the battery contacting with those on the charger and push it down until it clicks into place.

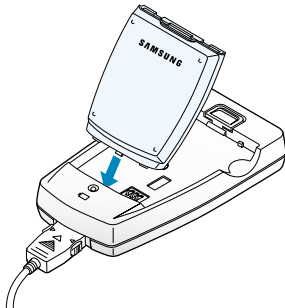

3. Connect the adapter to a standard AC wall outlet.

You can see the LED on the charger indicating the charging progress with the following color:

- Red: the battery is charging
- Green: charging is completed

4. When charging is finished, take the battery out of the desktop charger.

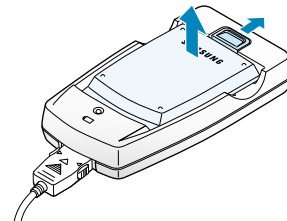

5. Disconnect the adapter from both the power outlet and the charger.

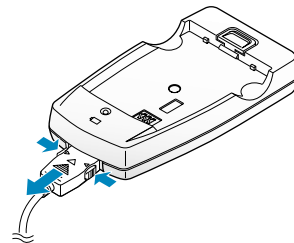

Low Battery Indicator

When the battery is weak and only a few minutes of talk time remain, you will hear a warning tone and a message will be repeated at regular intervals on the display:

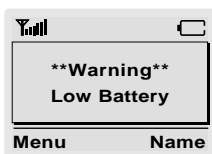

When the battery becomes too weak for the phone to operate, it switches off automatically.

Switching the Phone On/Off

1. Open the phone.
2. Hold down the  key for more than one second to switch the phone on.
3. If the phone asks for a password, key in the password and press the **OK** soft key. The phone password is factory set to 00000000. For further details, see page 127.

4. If the phone asks for a PIN, key in the PIN and press the **OK** soft key. For further details, see page 127.

The phone searches for your network and when it finds it, the idle screen, illustrated below, is displayed. Now, you can make or receive a call.

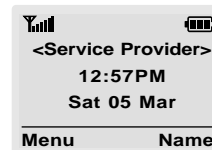

Notes:

- If your SIM supports the AoC (Advice of Charge) feature or the **Receive** menu option (2.5.2) in the **Broadcast** menu option (see page 80) is set to **Enable**, the current date will be replaced by the received message or AoC information. To retrieve it, press the **C** key once (or twice).
 - The display language is factory set to English. To change the language, use the **Language** menu option (4.5); for further details, refer to page 92.
5. When you wish to switch the phone off, hold down the  key for more than two seconds.

General Functions

Making a Call

When the idle screen is displayed, key in the area code and phone number and press the  key.

Note: If you have set the **Auto Redial** menu option (4.7) to **ON** (see page 93) and the person called does not answer or is already on the phone, the number is redialled automatically up to ten times.

Making International Calls

1. Press and hold down the **0** key.
The + character appears.
2. Key in the country code, area code and phone number and press the  key.

Correcting the Number

To clear...	Then...
The last digit displayed	Press the C key.
Any other digit in the number	Press the ◀ or ▶ key until the cursor is immediately to the right of the digit to be cleared. Press the C key. You can also insert a missing digit simply by pressing the appropriate key.
The whole display	Hold down the C key for more than one second.

Ending a Call



When you have finished your call, briefly press the  key.

Making a Call from the Phonebook

You can store the names and phone numbers dialled regularly in the SIM card and phone memory, called the phonebook. You then simply select the required name to recall the associated number. For further details on the Phonebook feature, refer to page 34.

Redialling the Last Number



The phone stores the last 10 numbers dialled. To recall any of these numbers, proceed as follows.

1. If you have typed any characters on the display, the  key to return to idle mode.
2. Press the  key to display a list of the last numbers dialled.
3. Use the **▲** or **▼** keys to scroll through the numbers until the required number is highlighted.

4. **To...** Dial the number highlighted
Edit the number highlighted
- Then...** Press the  key.
 - Press the **Edit** soft key.
 - Change the number as required, referring to Correcting the Number on page 24 for further details.

Adjusting the Volume

During a call, if you want to adjust the earpiece volume, use the volume keys on the left side of the phone.

Press the  key to increase and the  key to decrease the volume.

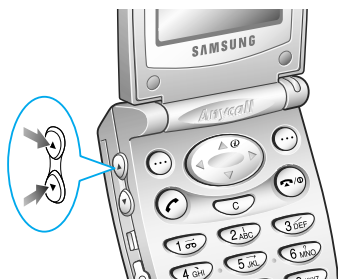

In idle mode with the flip cover open, you can adjust the key volume using the  and  keys.

Answering a Call

When somebody calls you, the phone rings and the phone icon in the middle of the screen flashes.

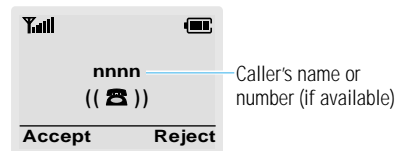

If the caller can be identified, the caller's phone number (or name if stored in your phonebook) is displayed. If the caller cannot be identified, only the phone icon flashes.

1. If necessary, open the flip cover. Press the  key or the **Accept** soft key to answer the incoming call.

If the **Anykey Answer** menu option (4.9) is set to **ON**, you can press any key to answer a call except for the  key and the **Reject** soft key (see page 94).

Notes:

- To reject an incoming call, press and hold the volume keys on the left side of the phone without opening the flip.
- If the **Active Flip** menu option (4.8) is set to **Enable**, you do not need to press any key. You can answer the call simply by opening the flip (see page 93).

2. End the call by closing the phone or pressing the  key.

Note: You can answer a call while using the phonebook or menu features.

Viewing Missed Calls

If you are unable to answer a call for any reason, you can find out who was calling you, provided that this service is available. In this way, you can call the person back, if necessary.

The number of missed calls is displayed on the idle screen immediately after the call was missed.

To view the missed call immediately, proceed as follows.

1. If the phone is closed, open the flip cover.
2. Press the **View** soft key.

The number corresponding to the most recent missed call is displayed, if available.

- | | |
|-------------------------------------|--|
| 3. To... | Then press the... |
| Scroll through the missed calls | ▲ and ▼ keys. |
| Call the number displayed |  key. |
| Edit or delete a missed call number | Select soft key (see next page). |

Editing a Missed Call Number

Note: If the number corresponding to the missed call is not available, the **Edit Number** option is not displayed.

1. Press the **Options** soft key.
2. If necessary, press the ▲ or ▼ key to highlight the **Edit Number** option.
3. Press the **Select** soft key.
4. Change the number as required.

- | | |
|------------------|--|
| 5. To... | Then press the... |
| Call the number |  key. |
| Store the number | Save soft key and enter the name and location required (for further details, refer to page 34). |

Deleting a Missed Call

1. Press the **Options** soft key.
2. If necessary, press the ▲ or ▼ key to highlight the **Delete** option.
3. Press the **Select** soft key.

You can press the  key at any time to exit the Missed Call feature.

Note: You can access the Missed Call feature at any time by selecting the **Missed Calls** menu option (1.1); for further details, see page 73.

Selecting Functions and Options

Your phone offers a set of functions that allow you to customise your phone. These functions are arranged in menus and sub-menus, accessed via the two soft keys marked ☺. Each menu and sub-menu allows you to view and alter the settings of a particular function.

The roles of the soft keys vary according to the current context; the label on the bottom line of the display just above each key indicates its current role.

Example:

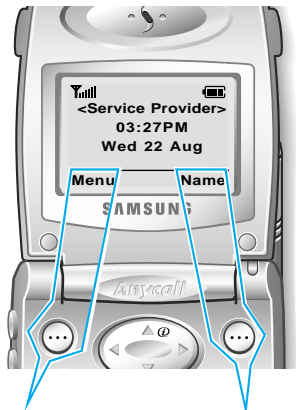

Press the left soft key to enter the main menu facility.

Press the right soft key to search for a Phonebook entry by its name.

To view the various functions/options available and select the one required, proceed as follows.

1. Press the appropriate soft key.
2. **To...**

Select the:

 - Function displayed
 - or
 - Option highlighted

View the next function or highlight the next option in a list

Move back to the previous function or option in a list

Move back up one level in the structure

Exit the structure without changing the settings

Then press the...

Select soft key or ► key.

▼ key or Ⓢ key on the left side of the phone.

▲ key or Ⓢ key on the left side of the phone.

◀ key, ↻ soft key or C key.

☺/Ⓢ key.

In some functions, you may be asked for a password or PIN. Enter the required code and press the **OK** soft key.

Note: When you access a list of options, your phone highlights the current option. If, however, there are only two options, such as On/Off or Enable/Disable, your phone highlights the option that is not currently active, so that you can select it directly.

Example: Setting the Display Language

1. When the idle screen is displayed, press the **Menu** soft key to enter the menu facility.

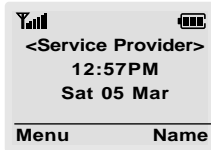

2. Scroll through the menus until you reach the **Phone Settings** menu, by pressing the ▲ and ▼ keys.

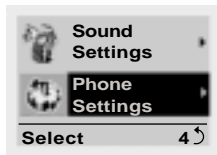

3. To select the **Phone Settings** menu, press the **Select** soft key or ► key.

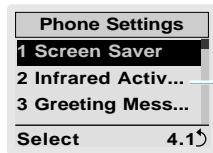

If the menu name is too long for the display, it is scrolled when highlighted.

4. Scroll through the sub-menus until you reach the **Language** sub-menu, by pressing the ▲ and ▼ keys.

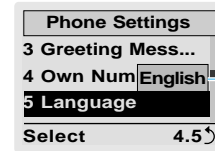

Shows the current setting

5. To view the languages available, press the **Select** soft key or the ► key. The current setting is highlighted.

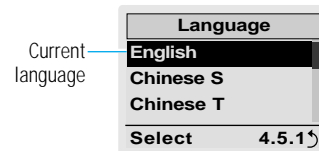

Current language

6. Scroll through the list of languages until the appropriate one is highlighted, by pressing the ▲ and ▼ keys.
7. Press the **Select** soft key or the ► key to confirm your selection.
8. Press the **C** or ◀ key twice to exit the menu structure.

Phonebook

You can store phone numbers and their corresponding names in the memory of your SIM card. In addition, you can store up to 99 numbers and names in the phone memory. The SIM card and phone memories, although physically separate, are used as if they were a single entity, called the phonebook.

Storing a Phone Number with a Name

As soon as you start to enter a number, **Save** appears above the left soft key to allow you to store the number in the phonebook.

1. Key in the number to be stored.

Note: If you make a mistake while entering a number, correct it using the **C** key. For further details, refer to page 24.

2. When you are sure that it is correct, press the **Save** soft key.
3. Enter the corresponding name (the maximum length depends on your SIM card). For information on how to enter a name, see page 41.
4. When you are satisfied, press the **OK** soft key. The phone now displays the first free location in the last memory used to save a number and name. If that memory is full, the first free location in the other memory is displayed.
5. Press the right soft key to toggle between the phone (**To Phone**) and card (**To Card**) memories.

6. If you do not want to save the number and name in the suggested location, press the **C** key to clear the location number and enter your preferred location by pressing the number keys.
7. Press **OK** to store the name and number.
8. Press **⏪/⊗** to return to the idle screen.

Speed-Dialling by Memory Location

Once you have stored phone numbers in the SIM card, you can dial them easily whenever you want.

To speed-dial a number, proceed as follows.

To speed-dial number in locations...

2 to 9

Press and hold down the appropriate key.

10 and above

- Press the appropriate keys, followed by the **#** key. The display shows the name, phone number and location.
- To dial the number, press the **Dial** soft key.

Note: Memory location 1 is reserved for your Voice Mail server number.

Searching for and Dialling a Number in the Phonebook

1. When the idle screen is displayed, press the **Name** soft key. You are asked to enter a name.
2. Enter the start of the name that you wish to find and press the **Search** soft key.

Note: You can also scroll through the phonebook from the beginning, by pressing the **Search** soft key directly.

The phonebook entries are listed, starting with the first entry matching your input. This entry is also highlighted.

- | | |
|--|---|
| 3. To... | Then press the... |
| View the highlighted entry | View soft key. |
| Select a different entry | ▲ or ▼ key one or more times until the required entry is highlighted. |
| Look for a name starting with a different letter | Key labelled with the required letter. |
4. Once you have found the required entry, press the  key to dial the number.

Phonebook Options

When storing or viewing a number in the phonebook, **Options** appears above the left soft key to allow you to access the phonebook options, described in the following paragraphs.

Accessing the Options

To access the various phonebook options, proceed as follows.

- | | |
|--|--|
| 1. Press the Options soft key. The first available option is highlighted. | |
| 2. To... | Then press the... |
| Select the highlighted option | Select soft key or ► key. |
| Highlight a different option | ▲ or ▼ key one or more times until the required option is highlighted. |

Paste

This option allows you to paste the phonebook number into the normal dialling mode. Use this option to dial a number similar to one in the phonebook (a different extension in the same office for example).

Use the **C** key to change the number as required (refer to page 24 for further details). When you are ready to dial, press the  key.

Edit

This option allows you to edit a number and name stored in the phonebook.

Erase

This option allows you to erase a number and name stored in the phonebook. You are asked to confirm that you wish to erase the name and number from the phonebook by pressing the **Yes** soft key.

Copy

This option allows you to copy a phonebook number to another location. Use this option to store a number similar to one already in memory; once copied, edit the number and store it in the phonebook.

Caller Group

You can set the phone to ring in a specific way and display a preselected graphic icon when a particular person calls you. To do so, you must:

- Define your caller groups
- Assign the numbers in the phonebook to the appropriate group

Defining a caller group

You can define up to five caller groups.

1. In the idle mode, press the **Name** soft key.
2. Press the **Search** soft key .
3. Press the **Options** soft key.

4. Select the **Caller group** option.
5. Select the group to be defined.
6. Set the appropriate options.

The following options are available.

Call ring tone: allows you to select the ring tone to be used when you receive a voice phone call from a person in the group.

SMS tone: allows you to select the ring tone to be used when you receive a text message from a person in the group.

Graphic: allows you to select the graphic icon to be displayed when you receive a call from a person in the group.

Group Name: allows you to assign a name to the group; for further details on how to enter characters, refer to page 41.

Assigning numbers to a group

1. View the required number in the phonebook.
2. Press the **Options** soft key.
3. Select the **Caller Group** option.
4. Select the required group.

To remove a number from a group, select the **No Group** option.

Memory Status

You can check how many names and numbers are stored in the phonebook (card and phone memories). Proceed as follows.

1. In the idle mode, press the **Name** soft key.
2. Press the **Search** soft key.
3. Press the **Options** soft key.
4. Select the **Memory Status** option.
5. Press **Next** to toggle between the card and phone memories.

SDN

You can view the list of Service Dialling Numbers (SDN) assigned by your network provider. Such numbers include the emergency, directory enquiries and voice mail numbers.

1. In the idle mode, press the **Name** soft key.
2. Press the **Search** soft key .
3. Press the **Options** soft key.
4. Select the **SDN** option.
5. Scroll through the numbers using the ▲ and ▼ keys.
6. To dial the number displayed, press the **Dial** soft key.

Note: This option is available only when your SIM card supports Service Dialling Numbers (SDN).

Entering Text

The phone allows you to enter characters for messages and names in Chinese and English. To enter Chinese text, the phone provides several widely used pronunciation based (Pinyin) and character shape based (Stroke) input methods to meet the preferences of different users, allowing for greater convenience and ease of use.

You can also enter any combination of Chinese characters, alphabets, numbers, and special symbols including punctuation marks.

The following text input modes are available on your phone:

- Pinyin mode
- Chinese Simplified Stroke mode
- Quick English mode
- English mode
- Chinese Traditional Stroke mode
- Number mode
- Symbolic mode
- Help mode

Directions for using each of the text input modes appears later in this section.

Changing Text Input Mode

When you are in a field that allows character entry, you should notice the text input mode indicator at the bottom of the display.



Text mode indicator

You can change between Chinese input methods, and English or to numbers input. To change to another text input mode:

1. Press the right soft key, indicating **Mode** or the text input mode.

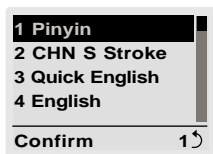

2. Scroll to the desired mode with the ▲ and ▼ keys.
3. To select the displayed mode, press the **Confirm** soft key.

4. You will find the selected text input mode indicator at the bottom of the display.

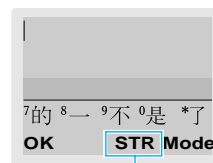

Currently selected mode

- Chinese Pinyin mode → PY
- Chinese Simplified Stroke mode → STR
- Quick English mode → ENG
- English mode → ABC
- Chinese Traditional Stroke mode → STR
- Number mode → NUM
- Symbolic mode → SYM
- Help mode → HELP

Note: If you want to exit the menu without changing to a new mode, press the right soft key.

Chinese Pinyin Mode

Pinyin is a system to mark Chinese pronunciation in Latin alphabets. With the pinyin input method, you can enter Chinese characters by keying in the pinyin string from the phone keypad and the phone automatically presents the matching alternatives.

This mode allows you to enter Pinyin characters with only one key press per letter. When the phone is in the Pinyin mode, keys behave as follows:

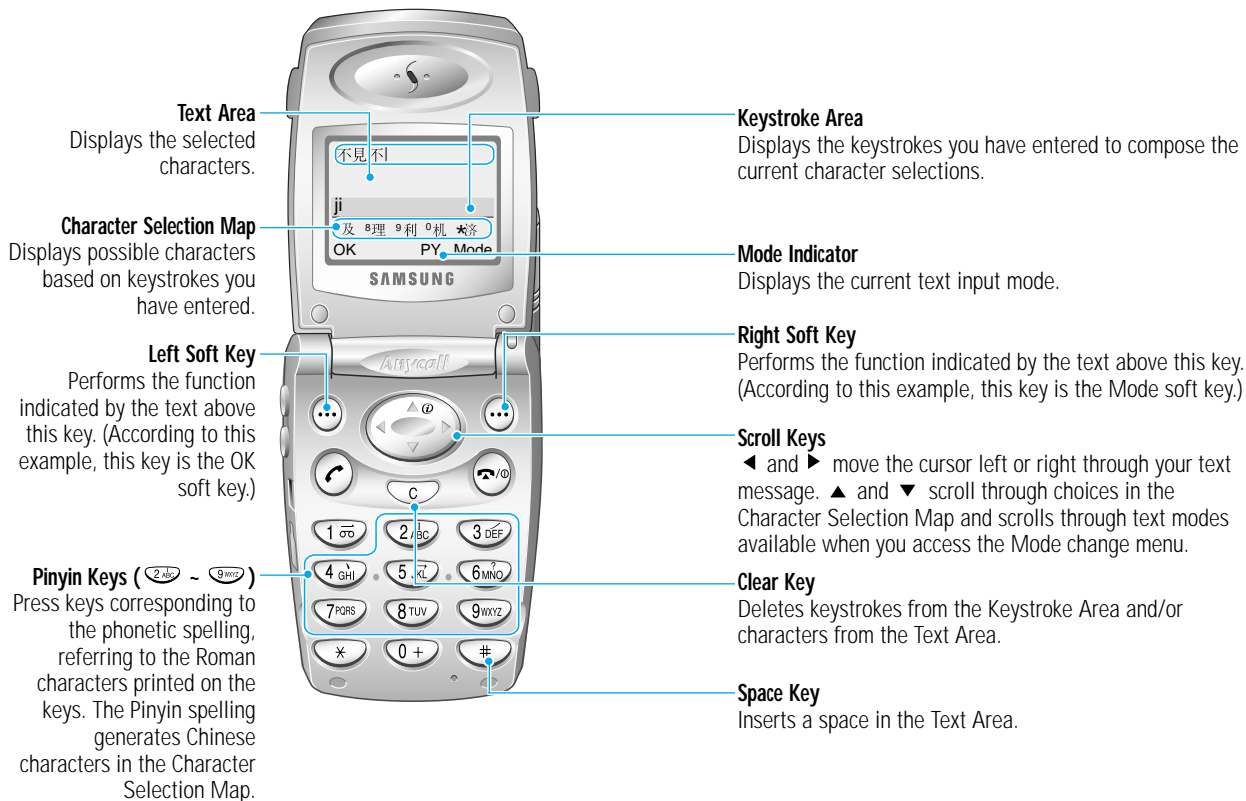

Typing Characters in Pinyin Mode

1. Press keys corresponding to the phonetic spelling, referring to the Roman letters printed on the keys. Notice that the choices in the Character Selection Map change.

Example: Typing 力 in Pinyin mode

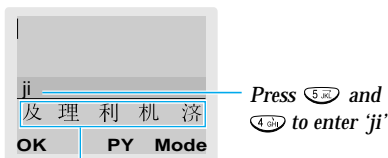

The Character Selection Map.

2. To scroll through choices in the Character Selection map, press the ▼ key. To move back, press the ▲ key.

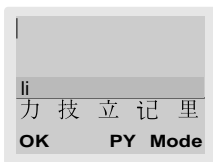

When the character you are typing appears in the Character Selection Map, you may select it, without completing the Pinyin spelling or entering the tone for the character.

3. To select a character, press the **1** key to activate the Character Selection Map. A number (7 to *) is added to the beginning of a corresponding character. With the Character Selection Map being activated, a normal press on **7** to * selects the corresponding character.

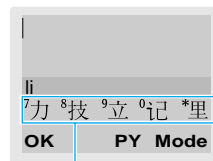

Press **7** to select 力 with the Character Selection Map being activated.

Inserting a Space

To insert a space when entering a text, press the # key when the cursor blinks in the Text Area.

Scrolling

To move the cursor left or right through your text message, press the ◀ or ▶ key.

When the phone is in the Chinese Stroke mode, keys behave as follows:

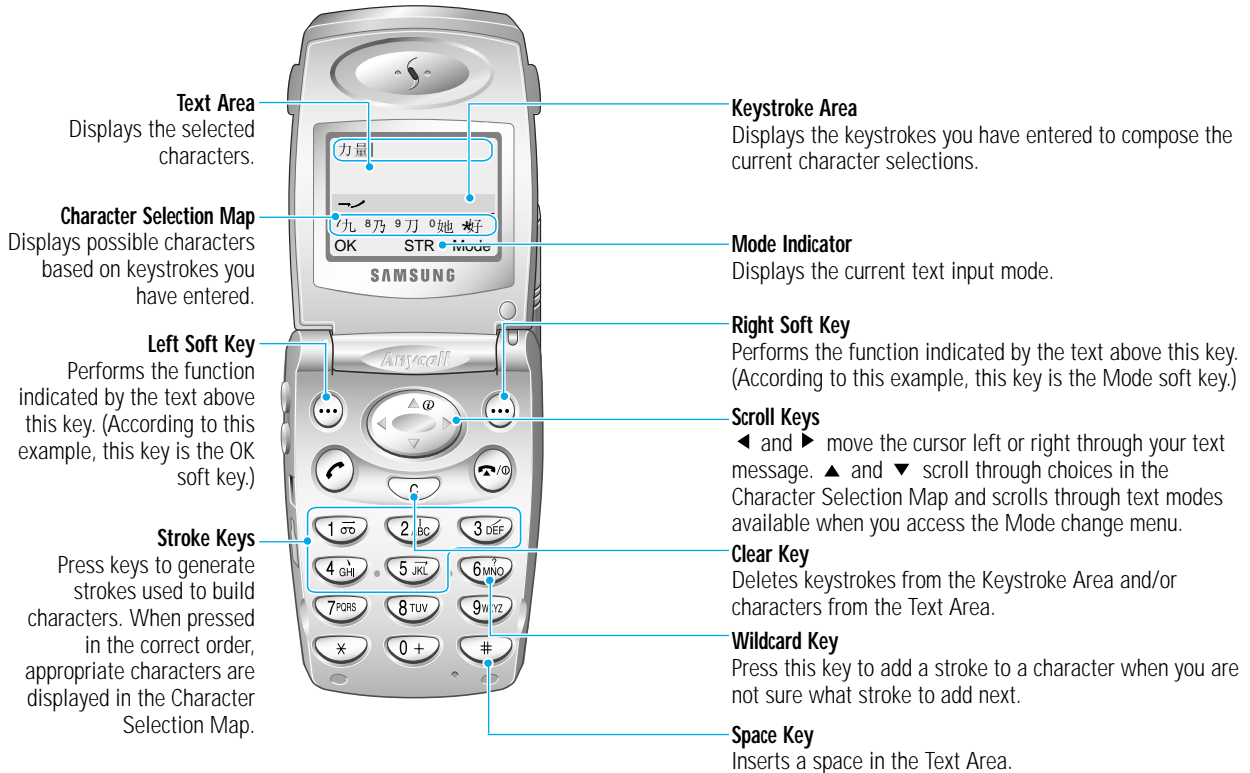

Typing Stokes and Characters in Stroke Mode

1. To type a character, press keys corresponding to its component strokes. Press keys on the handset in the order that you would write the strokes, using one press per desired stroke.

Example: Typing (力) in Stroke mode

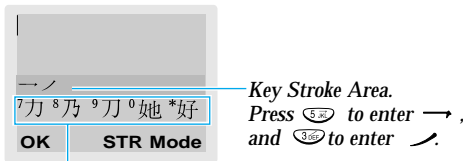

The Character Selection Map.
To select 力, press **7**.

2. The phone displays your strokes in the Key Stroke Area and offers character choices in the Character Selection Map. As you enter strokes, notice that the choices in the Character Selection Map change. To scroll through choices in the Character Selection Map, press the **▼** key. To move back, press the **▲** key.
3. When the character you are typing appears in the Character Selection Map, you may select it without finishing the stroke sequence for the character. Characters displayed in the Character Selection Map correspond to keys **7** to ***** on the keypad. To select a character from the Character Selection Map and add it to your message, press the corresponding key **7** to *****.

Note: If you are uncertain of the order of one or more strokes, press the **6** key in place of each questionable stroke. Continue entering strokes until the character is displayed in the Character Selection Map or until you have finished the character.

Scrolling

To move the cursor left or right through your text message, press the **◀** or **▶** key.

Clearing Letters and Words

Press the **C** key one or more times to remove strokes to the left. Once the Stroke Area is empty, pressing the **C** key removes characters from the Text Area.

Rapid Character Entry

Rapid character entry is easy in any mode, using the Character Selection Map. As you enter characters, your phone predicts the next character you might want and presents choices in the Character Selection Map area. When a desired character appears, you may select it as described above.

In most cases, you will see the desired character in the Character Selection Map area before you have entered all of the strokes to build it.

For example, try typing the twelve stroke character pair “中国” using the following keystrokes; **2, 8** and **7**. Even though “中国” is a twelve stroke character pair, your phone enables you to type it in only three key presses!

Quick English Mode

This mode allows you to enter English words with only one keypress per letter. Each key on a keypad has more than one letter - a single press on the **5** key could be J, K, or L. The **Quick English** mode automatically compares your key presses to an internal **Quick English** linguistic database to determine the correct word.

The mode requires far fewer keystrokes than the traditional multi-tap method; **English** mode.

Typing English Words

To type a word, press keys corresponding to the letters you need. Remember the following as you are typing:

1. Press keys on the handset just once per desired letter. For example, to enter 'hello', press **4** (ohv), **3** (pq), **5** (jkl), **5** (jkl), **6** (mno).
2. The word you are typing appears in the display. It may change with each key you press.
3. Type to the end of the word before editing or deleting any keystrokes.
4. Complete each word with a space by pressing the **#** key.

If the word that appears in the display is not the word that you desire, press the **0** key one or more times to display alternate word choices for the keys you have typed. (For example, 'of' and 'me' both shares the sequence **6, 3**. The phone displays the most commonly used choice first.)

To type words not found in the phone database, change the text input mode to English mode.

Smart Punctuations

Period, hyphen, and apostrophe are available on the **1** key. T9 applies rules of grammar to insert the correct punctuation. Notice that the **1** key is used twice in this example to display two punctuation marks:

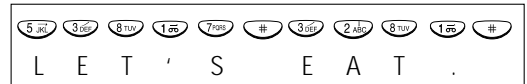

Upper Case Letters

There are two shift states: Lower Case and Caps Lock. Press the ***** key one or more times to display the appropriate shift indicator, and begin typing normally.

Scrolling

- To move the cursor left or right through your text message, press the **◀** or **▶** key.
- To scroll through alternate word choices for the keys you have entered, press the **0** key.

Clearing Letters and Words

Press the **C** key one or more times to remove letters to the left. Press and hold the **C** key to erase entire words.

English Mode

When typing in English mode, you should press key labelled with the required character:

- Once for the first character
- Twice for the second character
- and so on.

For example, you press the **2** key three times quickly to display the character “C”, the **5** key two times quickly to display the character “L”. So, this method is called Multi-tap typing.

The cursor moves to the right when you press a different key. When entering the same character twice (or a different character on the same key), just wait for a few seconds for the cursor to move right automatically, and select the next character.

Complete each word with a space by pressing the **#** key.

Refer to the table on next page for the list of characters assigned on each key.

List of characters available:

Key	Characters in the Order Displayed	
	Upper Case	Lower Case
1	Space . 1 ! ? & i ¿ \$. % @ _ £ \$ ¥ ¤ §
2	A B C 2	a b c 2
3	D E F 3	d e f 3
4	G H I 4	g h i 4
5	J K L 5	j k l 5
6	M N O 6	m n o 6
7	P Q R S 7	p q r s 7
8	T U V 8	t u v 8
9	W X Y Z 9	w x y z 9
0	0 * # , ; ' " =	/ : - + () < >

Upper Case Letters

To shift the case of the next character(s) that you type, press the ***** key one or more times. There are two shift states: Lower Case and Caps Lock.

Scrolling

To move the cursor left or right through your text message, press the **◀** or **▶** key.

Clearing Letters and Words

Press the **C** key one or more times to remove letters to the left. Press and hold the **C** key to erase entire words.

Number Mode

Number mode enables you to enter numbers into a text message. Press keys corresponding to the desired digits, and manually switch back to the text entry mode of choice.

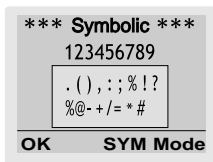

Symbolic Mode

Symbolic mode enables you to enter symbols into a text message.

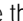

To scroll through the symbols available, press the  key. Press the keys corresponding to the desired mark and then the phone automatically switches back to the text entry mode used just prior to selecting Symbols mode.

Using Help

On-screen help is available by selecting Help from the Mode menu. Use the  and  keys to scroll through the Help information.

In-Call Options

Your phone provides a number of control functions that you can use during a call.

Putting a Call on Hold

You can place the current call on hold whenever you want. You can make another call while you have a call in progress if this service is supported by the network. Of these two calls, one is active and the other is on hold and you can swap between the calls.

To place a call on hold, simply press the **Hold** soft key. You can reactivate the call whenever you want, by pressing the **Unhold** soft key.

To make a call while you have a call in progress, proceed as follows.

1. Key in the phone number that you wish to dial or look it up in the phonebook.
2. Press the  key to dial the second call. The first call is automatically put on hold.

Or alternatively, proceed as follows.

1. Put the current call on hold by pressing the **Hold** soft key.
2. Make the second call in the normal way.

To swap between the two calls, simply press the **Swap** soft key.

The current call is placed on hold and the call on hold is reactivated so that you can continue conversing with the other party.

When you have finished, end each call normally by pressing the  key.

Switching the Microphone Off (Mute)

You can temporarily switch your phone's microphone off, so that the other party cannot hear you.

Example: You wish to say something to another person in the room but do not want the other party to hear you.

To switch the microphone off temporarily, proceed as follows.

1. Press the **Options** soft key.
2. If necessary, press the ▼ key to highlight the **Mute** option.
3. Press the **OK** soft key.

The other party can no longer hear you.

To switch the microphone back on, proceed as follows.

1. Press the **Options** soft key.
2. If necessary, press the ▼ key to highlight the **Unmute** option.
3. Press the **OK** soft key.

The other party can hear you again.

Muting/Sending Key Tones

These options allow you to turn the key tones off or on. If the **Mute keys** option is selected, your phone does not transmit the key tones. It allows you to press keys without hearing annoying key tones during a call.

Note: To communicate with answering machines or computerised telephony systems, the **Send keys** option must be selected.

Searching for a Number in the Phonebook

You can search for a number in the phonebook during a call.

1. Press the **Options** soft key.
2. Press the ▼ key to highlight the **Phonebook** option.
3. Press the **OK** soft key.
The phonebook entries are listed.
4. Enter the name that you wish to find.

If you enter the start of the name, all phonebook entries are listed, starting with the first entry matching your input. The entry is also highlighted.

5. To view the highlighted entry, press the **View** soft key.

For a more detailed description of the Phonebook feature, refer to page 34.

Using the SMS Service

If you receive an SMS (Short Message Service) message during a call, the message icon (✉) flashes in the display. The **SMS Service** option enables you to use this feature.

Read Messages: allows you to read the messages that you have received.

Write Messages: allows you to write a message.

For further details on the SMS service, refer to page 76.

Answering a Second Call

You can answer an incoming call while you have a call in progress, if this service is supported by the network and you have set the **Call Waiting** menu option (7.3) to **Activate** (see page 112). You will be notified of an incoming call by a call waiting tone.

To answer a call while you have a call in progress, proceed as follows.

1. Press the  key to answer the incoming call.
The first call is automatically put on hold.
2. To switch between the two calls, press the **Swap** soft key.

To end a held call, press the **Options** soft key and select the **End Held Call** option.

3. To end the current call, press the  key.

Making a Multiparty Call

A multiparty call is a network service that allows up to six people to take part simultaneously in a multiparty or conference call. For more information, contact your service provider.

Setting up the Multiparty Call

1. Call the first participant in the normal way.
2. Call the second participant in the normal way. The first call is automatically put on hold.
3. To join the first participant to the multiparty call, press the **Options** soft key and select the **Join** option.
4. To add a new person to the multiparty call, call the person in the normal way, press the **Options** soft key and select the **Join** option.



You can add incoming callers by answering the call and pressing **Options**, followed by **Join**. Repeat as required.

Having a Private Conversation With One Participant

1. Press the **Options** soft key and choose the **Select one** option.
The list of call participants appears.

2. Highlight the required person, by pressing the ▲ or ▼ key, followed by the **Select** soft key or the  key.
3. Select **Private**.
Now you can talk privately with that person. The other participants can continue to converse with each other.
4. To return to the multiparty call, press the **Options** soft key and select **Join**.
All the multiparty call participants can now hear each other.

Dropping One Participant

1. Press the **Options** soft key and choose the **Select one** option.
The list of call participants appears.
2. Highlight the required person, by pressing the ▲ or ▼ key, followed by the **Select** soft key or the  key.
3. Select **Remove**.
The call is ended with that participant, but you can continue to talk with the other participants.
4. End the multiparty call by closing the phone or pressing the  key.

Using the Menus

The phone offers a range of functions that allow you to tailor the phone to your needs. These functions are arranged in menus and sub-menus.

The menus and sub-menus can be accessed by using the navigation keys or by using the index system.

Accessing a Menu Function by Scrolling

1. In idle mode, press the **Menu** soft key to access the menu facility. Scroll with the ▲ and ▼ keys to reach the desired main menu, e.g. **Phone Settings**. Press the **Select** soft key to enter the menu.
2. If the menu contains any submenus: for example, **Language**, find the one you want by scrolling with the ▲ and ▼ keys. Press the **Select** soft key to enter the submenu.
If the menu you have selected contains submenus, repeat this step.
3. Scroll with the ▲ and ▼ keys to find the setting of your choice. Press the **Select** soft key to confirm the chosen setting.

Notes:

- You can return the previous menu level by pressing the ↵ soft key.
- You can exit the menu without changing the menu settings by pressing the ⏏/Ⓞ key.

Accessing a Menu Function by Using its Shortcut

The menu items (menu, submenu and setting options) are numbered and can be accessed quickly by using their shortcut number. The shortcut number is shown in the right-bottom next to the ↵ soft key on the display.

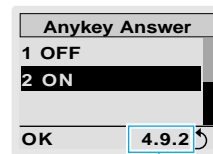

Shortcut number

1. In idle mode, press the **Menu** soft key.
2. Within three seconds, key in the first digit of the shortcut number. Repeat this for each digit of the shortcut number.

Example: Setting the **Any-key Answer** function

Press the **Menu** soft key, and key in **4** **9**, **2**.

Menu for entering the menu, **4** for **Phone Settings**, **9** for **Anykey Answer** for menu function and **2** to set the Any-key Answer **ON**.

Note: The numbers assigned to each menu function are indicated on the list on page 68. They may not match the menu number on the phone. It depends on the services supported by the SIM.

List of Menu Functions

The following illustration shows the menu structure available and indicates the:

- Number assigned to each option
- Page on which you can find a description of each feature

Note: If you use a SIM AT card that provides additional services, the **SIM AT** menu (**0**) is displayed first when you press the **Menu** soft key to enter the menu facility. For further details, refer to your SIM card documentation.

1. Call Records (see page 73)

- 1.1 Missed Calls
- 1.2 Received Calls
- 1.3 Dialed Calls
- 1.4 Call Time
 - 1.4.1 Last Call Time
 - 1.4.2 Total Sent
 - 1.4.3 Total Received
 - 1.4.4 Reset Timers
- 1.5 Call Cost *
 - 1.5.1 Last Call Cost
 - 1.5.2 Total Cost
 - 1.5.3 Max Cost
 - 1.5.4 Reset Counters
 - 1.5.5 Set Max Cost
 - 1.5.6 Price/Unit

2. Messages (see page 76)

- 2.1 Read Messages
 - 2.1.1 Inbox
 - 2.1.2 Outbox
- 2.2 Write Messages
- 2.3 Preset Messages

2. Messages (continued)

- 2.4 Setup
 - 2.4.1 Setting 1 *
 - 2.4.2 Setting 2 *
 - 2.4.3 Common Setting
- 2.5 Broadcast
 - 2.5.1 Read
 - 2.5.2 Receive
 - 2.5.3 Channel List
 - 2.5.3.1 Select
 - 2.5.3.2 Add Channel
 - 2.5.3.3 Delete
 - 2.5.3.4 Edit
 - 2.5.4 Language
- 2.6 Voice Mail
 - 2.6.1 Connect to Voice Server
 - 2.6.2 Voice Server

3. Sound Settings (see page 83)

- 3.1 Ring Tone
- 3.2 Melody Composer
- 3.3 Ring Volume
- 3.4 Alert Type
- 3.5 Keypad Tone
- 3.6 Message Tone
- 3.7 Error Tone
- 3.8 Minute Minder
- 3.9 Connect Tone

4. Phone Settings (see page 89)

- 4.1 Screen Saver
- 4.2 Infrared Activate
- 4.3 Greeting Message
- 4.4 Own Number
- 4.5 Language

* Shown only if supported by your SIM card.

* Shown only if supported by your SIM card.

4. Phone Settings (continued)

- 4.6 Light
- 4.7 Auto Redial
- 4.8 Active Flip
- 4.9 Anykey Answer
- 4.0 Contrast
- 4.* Reset Settings

5. Organiser (see page 95)

- 5.1 Calendar
- 5.2 To Do List
- 5.3 Time & Date
 - 5.3.1 Set Time
 - 5.3.2 Set Date
 - 5.3.3 World Time
 - 5.3.4 Format
- 5.4 Alarm
 - 5.4.1 Once Alarm
 - 5.4.2 Daily Alarm
 - 5.4.3 Weekly Alarm
 - 5.4.4 Remove Alarm
 - 5.4.5 Autopower
- 5.5 Calculator
- 5.6 ShortCut
 - 5.6.1 Key down
 - 5.6.2 Key right
 - 5.6.3 Key left
 - 5.6.4 C long press

6. Security (see page 104)

- 6.1 PIN Check
- 6.2 Change PIN
- 6.3 Phone Lock
- 6.4 Change Password
- 6.5 SIM Lock
- 6.6 FDN Mode *
- 6.7 Change PIN2 *

7. Network Services (see page 108)

- 7.1 Call Diverting
 - 7.1.1 Divert Always
 - 7.1.2 Busy
 - 7.1.3 No Reply
 - 7.1.4 Unreachable
 - 7.1.5 Cancel All
- 7.2 Call Barring
 - 7.2.1 All Outgoing
 - 7.2.2 International
 - 7.2.3 International Except to Home
 - 7.2.4 All Incoming
 - 7.2.5 Incoming While Abroad
 - 7.2.6 Cancel All
 - 7.2.7 Change Barring Password
- 7.3 Call Waiting
 - 7.3.1 Voice Calls
 - 7.3.2 Cancel All
- 7.4 Network Selection
 - 7.4.1 Automatic
 - 7.4.2 Manual
- 7.5 Caller ID
 - 7.5.1 Default
 - 7.5.2 Hide Number
 - 7.5.3 Send Number
- 7.6 Closed User Group
 - 7.6.1 Index List
 - 7.6.2 Outside Access
 - 7.6.3 Default Group
 - 7.6.4 Deactivate *

* Shown only if the Closed User Group feature is activated.

8. WAP Browser (see page 117)

- 8.1 Home
- 8.2 Favorite
- 8.3 http://
- 8.4 Settings
- 8.5 Clear Cache

9. Life (see page 118)

- 9.1 Games
- 9.2 Health
 - 9.2.1 Bio Rhythm
 - 9.2.1.1 Today
 - 9.2.1.2 Special day
 - 9.2.1.3 Setup
 - 9.2.1.4 Help
 - 9.2.2 Fatness
 - 9.2.2.1 Calculate
 - 9.2.2.2 Help
 - 9.2.3 Calorie
 - 9.2.3.1 Daily Work
 - 9.2.3.2 Exercise
 - 9.2.3.3 Total
 - 9.2.4 Pink Schedule
 - 9.2.4.1 My Schedule
 - 9.2.4.2 Friend's Schedule
 - 9.2.4.3 Setup

Call Records

Via this menu, you can view the phone calls:

- Missed
- Received
- Dialed

The number and name (if available) are displayed, together with the date and time at which the call was made.

Note: Your phone can keep up to ten numbers in each list.

Missed Calls

Menu 1.1

This option lets you view the last 10 unanswered calls. You can also:

- Edit the number if available and dial it or save it in the phonebook
- Delete the call from the list

Received Calls

Menu 1.2

This option lets you view the last 10 phone calls received. You can also:

- Edit the number if available and dial it or save it in the phonebook
- Delete the call from the list

Dialled Calls

Menu 1.3

This option lets you view the last 10 numbers dialled. You can also:

- Delete the number
- Edit the number and save it in the phonebook
- Redial the number

Call Time

Menu 1.4

This option lets you view the timers for calls made and received. The following timers are available.

Last Call Time: length of the last call.

Total Sent: total length of all calls made since the timer was last reset.

Total Received: total length of all calls received since the timer was last reset.

Reset Timers: option used to reset the call timers; you must first enter the phone password (see page 127) and then press the **OK** soft key.

Note: The actual time invoiced for calls by your service provider may vary, depending on network features, rounding-off for billing purposes and so forth.

Call Cost^{*}

Menu 1.5

This network feature lets you view the cost of calls. The following options are available.

Last Call Cost: cost of the last call made.

Total Cost: total cost of all calls made since the cost counter was last reset. If the total cost exceeds the maximum cost set via the **Set Max Cost** option, you can no longer make any calls until you reset the counter.

Max Cost: maximum cost set via the **Set Max Cost** option (see below).

Reset Counters: option used to reset the cost counter; you must first enter your PIN2 (see page 128) and then press the **OK** soft key.

Set Max Cost: option used to enter the maximum cost that you authorise for your calls.

Price/Unit: option used to set the cost of one unit; this price per unit is applied when calculating the cost of your calls.

^{*} Shown only if supported by your SIM card.

Messages

The SMS (Short Message Service) function is a network service and may not be supported by your network. Messages can be sent by text, fax, Email and paging messaging systems, provided that these services are supported by your network. To send text messages by phone, you must obtain the number of the SMS centre from your service provider.

When the  icon appears, you have received new text messages. If the message memory is full, an error message is displayed and you cannot receive any new messages. Use the **Delete** option in the **Read Messages** menu (2.1) to delete obsolete messages.

Read Messages

Menu 2.1

Two message boxes are available.

Inbox: used to store the messages that you have received.

Outbox: used to store the messages that you have already sent or will send.

Select the required box. The list of messages in the box is displayed.

To view a message, highlight it in the list using the ▲ and ▼ key and press the **View** soft key. The screen shows the:

- Sender's phone number (if sent with the message) or name if it is available in your phonebook (inbox only)
- Date and time at which the message was received (inbox only)
- Message text

To scroll through the message, press the ▲ and ▼ keys.

You can choose the following options, by pressing the **Options** soft key.

Delete: allows you to delete obsolete messages.

Text Reply (inbox only): allows you to reply by sending a text message. You can also change the SMS centre number (if required).

Call Back (inbox only): allows you to call the sender back.

Cut Number: allows you to extract a number from the message text, so that you can call the number or save it in the phonebook.

Send: allows you to send a message that you have received or saved. You can:

- Send the message
- Save and send the message
- Save but not send the message

Edit Message: allows you to edit a message.

Note: The options available vary, depending on the message status (new/old, not sent or sent for example).

Write Messages

Menu 2.2

Via this menu, you can write text messages of up to 160 English characters or 70 Chinese characters.

Note: For further information on how to enter the characters in your message, refer to page 41.

After you complete the message, you can select the following options.

Send Only: enter the destination and select a setting group in which you set up default information on the SMS feature via the **Setup** menu (see the following page).

Save and Send: allows you to save a copy of the message and then send the message to the required destination. You are also required to select a setting group. You can read the message in your outbox using the **Read Messages** option.

Save Only: allows you to save the message so that it can be sent later. You can read the message in your outbox using the **Read Messages** option.

Preset Message

Menu 2.3

Using this menu, you can preset up to five messages that you use most frequently. This menu shows the preset message list. Scroll through the list using the ▲ and ▼ keys. When the required message number appears, press the **Options** soft key.

Edit: allows you to write a new message or edit the selected preset message.

Note: For further information on how to enter the characters in your message, refer to page 41.

Send Message: allows you to recall the selected message. Once you have completed the message, you can send, save and send, or simply save it.

Delete: allows you to delete the selected message. You are asked to confirm the deletion by pressing the **Yes** soft key.

Setup

Menu 2.4

Via this menu, you can set up default SMS information. A setting group is a collection of settings required to send messages. The number of setting groups available depends on the capacity of your SIM card.

Setting x (where **x** is the setting group number): each group has its own sub-menu.

Service Centre: allows you to store or change the number of your SMS centre required when sending messages. You must obtain this number from your service provider.

Default Type: allows you to set the default message type (Text, Fax, Email and Paging). The network can convert the messages into the selected format.

Default Validity: allows you to set the length of time for which your text messages will be stored at the message centre while attempts are made to deliver them to you.

Setting Name: allows you to give a name to the setting group currently being defined.

Common Setting: two options are available.

Reply Path: allows the recipient of your SMS message to send you a reply message via your message centre, if the service is provided by the network.

Delivery Reports: allows you to activate or deactivate the report function. When this function is activated, the network informs you whether your message has been delivered or not.

Broadcast

Menu 2.5

This network service allows you to receive text messages on various topics, such as the weather or traffic. Messages are displayed immediately they are received, provided that:

- The phone is in the idle mode
- The **Receive** option is set to **Enable**
- The message channel is currently active in the channel list

Note: When the received message are displayed in idle mode, pressing the **C** key retrieves the current date.

The last ten messages are also stored for later retrieval.

The following options are available.

Read: lets you view the first message. Scroll through the message using the ▲ and ▼ keys. At the end of the message, press the **Next** soft key to move to the next message.

Receive: allows you to enable or disable the reception of broadcast messages.

Channel List: allows you to indicate the channels from which you wish to receive broadcast messages. Several options are available.

Select: used to enable or disable channels in the list by marking or unmarking them respectively (a check mark is displayed in front of each channel selected).

Add Channel: used to declare the ID and title for a new channel.

Delete: used to remove a channel from the list.

Edit: used to change the ID and title of an existing channel.

Language: allows you to select your preferred language to be used when displaying cell broadcast messages.

Please contact your service provider for more information.

Voice Mail

Menu 2.6

This menu provides you with a quick way of accessing your voice mailbox (if provided by your network).

To quickly connect to the voice server, press and hold down the the **1** key in the idle mode.

Note: Voice Mail is a network feature. Please contact your service provider for more information.

Connect to Voice Server: before using this feature, you must enter the voice server number obtained from your service provider (see menu option **2.6.2**). You can then select this option and simply press the **OK** soft key to listen to your messages.

Voice Server: allows you to change the voice mail server number.

To...	Then press the...
Enter the server number	Corresponding numeric keys.
Correct a digit	C key.
Move the cursor to the left/right without clearing the digit	◀ or ▶ key.

Sound Settings

You can use the Sound Settings feature to customise various settings, such as the:

- Ringing tone or melody, volume and type
- Sounds made when you press a key, make an error or receive a message

Ring Tone

Menu 3.1

This option allows you to select the required ringing tone. You can choose between 48 different tones. Each time you select a tone, it is played for a few seconds. Two additional options correspond to the melodies that you can compose, using the **Melody Composer** menu option (**3.2**).

Melody Composer

Menu 3.2

This option allows you to compose your own melody to be used as the ring tone. Two octaves are available. A maximum of 100 notes can be entered. You can adjust the length of the notes and add rests, as required.

Composing a Melody

You can compose two melodies.

1. When you access the menu, the names of any melodies created are displayed. Otherwise, **Melody 1** and **Melody 2** appear. Select the melody that you wish to create or edit.

- Press the **Edit** soft key and compose your melody using the following keys.

To...	Then press the...
Enter a note between C and B (do and si)	1 to 7 keys respectively.
Move a note up or down one octave	8 key.
Insert the same note again	Next soft key.
Enter a rest	▶ key (press the key until the rest is of the required length).
Delete a note	C key.
Move a note a semitone up or down	▲ or ▼ key (for example, the note A changes to A#, B, C, C# and so on in the scale, each time you press the ▲ key).
Change the length of a note	◀ key (the length will be changed each time you press the key).
Listen to your melody	Listen soft key.
Modify your melody	Modify soft key.

- When you are satisfied with your melody, press the **Save** soft key.

- Enter a title for the melody.

Note: For further details on how to enter characters, refer to page 41.

You are asked if the melody is to become the ring tone.

- To use the melody as the ring tone, press the **Yes** soft key.

The melody is saved and is played each time your phone rings. You can also select the melodies composed via the **Ring Tone** menu option (3.1).

Otherwise, press the **No** soft key. The melody is saved only.

Deleting a Melody

- Select the melody that you wish to delete.
- Press the **Delete** soft key.
- You are asked to confirm that you wish to delete the melody by pressing the **Yes** soft key.

Ring Volume

Menu 3.3

This option allows you to adjust the ringing volume to one of five levels. Use the ▲ and ▼ keys or the ☺ and ☹ keys on the left side of the phone. The greater the number of bars, the greater the volume.

Alert Type

Menu 3.4

This option allows you to indicate how you are to be informed of any incoming calls. The following options are available.

Light only: only the backlight is switched on; the phone neither rings nor vibrates.

Melody: the phone rings using the ringing tone selected via the **Ring Tone** menu option (3.1).

Vibration: the phone vibrates but does not ring.

Note: In idle mode, you can set the phone to vibrate only (silent mode) or to start ringing again, simply by pressing one of the shortcut keys (for further details, see page 103).

Vibra+Melody: the phone first vibrates three times and then starts ringing.

Keypad Tone

Menu 3.5

This option allows you to select the tone that the keypad generates when you press a key. The following options are available.

OFF: the keys do not make any sound.

Tone: each key, when pressed, makes a different sound.

Beep: each key, when pressed, makes the same sound.

Message Tone

Menu 3.6

This option allows you to select how the phone informs you that a new message has been received.

The following options are available.

Light Only: the service light at the top of the phone flashes.

Single Beep: the phone beeps once.

SMS Tone1~10: the phone uses an SMS tone. You are provided with ten SMS tones.

Error Tone

Menu 3.7

This option allows you to select how the phone informs you that you have made a mistake.

The following options are available.

OFF: the phone does not beep.

ON: the phone beeps to indicate an invalid entry.

Minute Minder

Menu 3.8

This option allows you to specify whether the phone must beep every minute during an outgoing call to keep you informed of the length of your call.

The following options are available.

OFF: the phone does not beep.

ON: the phone beeps every minute.

Connect Tone

Menu 3.9

You can set your phone to beep when the person you are calling answers the phone.

The following options are available.

OFF: the phone does not beep.

ON: the phone beeps when your call is accepted.

Phone Settings

Many different features of your phone can be customised to suit your preferences. All of these features are accessed via the **Phone Settings** menu.

Screen Saver

Menu 4.1

This feature allows you to use the Screen Saver feature which displays a constantly shifting pattern or image on a display screen to prevent damage to the screen through continuous display of the same image.

Screen Mode

You can turn the Screen Saver feature on or off.

The following options are available.

OFF: Screen Saver is not used.

ON: the Screen Saver image selected in the Select Image menu option (**Menu 4.1.2**) is displayed after a preset time in idle mode. Pressing any key resumes the idle screen.

Select Image

This option allows you to select the image to be displayed when you set the Screen mode option to **On**.

The six images (**Picture 1 ~ 6**) are available.

Infrared Activate

Menu 4.2

This feature allows you to send or receive data/fax through the infrared port. To use an infrared connection, you must:

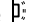
- Install the modem driver for receiving or sending data/fax. (We recommend 14400 bps Data/Fax modem manufactured by 'Rockwell' company.)
- Install the network dial-up software supplied by your service provider or a fax application program for a fax call on your PC
- Configure and activate an IrDA-compliant infrared port on your PC
- Activate the Infrared feature on the phone; the  symbol appears on the top line of the display
- Dial the network service number given to you by the service provider

If there is no communication between your phone and the IrDA-compliant device within 30 seconds of activating the feature, it is automatically deactivated.

For further details, contact your service provider.

For information on downloading and installing the IrDA program, visit <http://www.samsungmobile.com>.

Greeting Message

Menu 4.3

This option allows you to set a greeting message to be displayed briefly when the phone is switched on. The current message is displayed.

To...

Clear the existing message

Enter a new message

Change the text input mode

For further details on how to enter characters, refer to page 41.

Then press the...

C key and hold it down until the message is cleared.

Appropriate alphanumeric keys.

right soft key (indicating **Mode** or text input mode)

Own Number

Menu 4.4

This feature allows you to:

- Assign a name to each of your own phone numbers registered on your SIM card
- Edit the names and numbers

This function is a memory aid, which you can use to check your own phone numbers if you need to do so. Any changes made here do not in any way affect the actual subscriber numbers on your SIM card.

Language

Menu 4.5

You can select a display language. The available languages are **English**, **Chinese S** (simplified Chinese) and **Chinese T** (traditional Chinese).

Light

Menu 4.6

Back Light

You can select whether or not the phone uses the backlight. A marginal increase in standby/talk time can be achieved by turning the backlight off.

The following options are available.

OFF: the backlight is not used.

Short: the backlight comes on when you press a key or receive a call and switches off 10 seconds after the last key is pressed.

Long: the backlight comes on when you press a key or receive a call and switches off 20 seconds after the last key is pressed.

Service Light

This option allows you to select whether or not the service light on the top of the phone is used.

The following options are available.

OFF: the service light is not used.

ON: the service light flashes when the phone is ready for use.

Auto Redial

Menu 4.7

With the Auto Redial function, the phone makes up to ten attempts to redial a phone number after an unsuccessful call.

Note: The interval between two call attempts varies.

The following options are available.

OFF: the number is not redialled.

ON: the number is redialled automatically.

Active Flip

Menu 4.8

This option allows you to answer a call simply by opening the flip.

The following options are available.

Disable: to answer a call, you must open the flip and press a key, depending on the setting of the **Anykey Answer** menu option (page 94).



Enable: to answer a call, you simply open the flip.



Anykey Answer

Menu 4.9

This option allows you to answer an incoming call by pressing any key, except the  key and **Reject** soft key.

The following options are available.

ON: to answer a call, you can press any key except the  key and the **Reject** soft key. To reject the call, press the  key or the **Reject** soft key.

OFF: to answer a call, you can only press the  key or **Accept** soft key. To reject the call, the  key or the **Reject** soft key.

Contrast

Menu 4.0

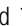
This option allows you to adjust the contrast of the LCD screen by pressing the  and  keys or the volume keys on the left side of the phone.

Reset Settings

Menu 4.*

You can easily reset your phone to its default configuration. To do so, proceed as follows.

1. Select the **Reset Settings** menu option.
2. Enter the 8-digit phone password.

Note: The password is preset to 00000000. To change this password, refer to page 106.

Organiser

The Organiser feature enables you to:

- View the calendar and organise your schedule
- Define a list of things to do
- Set the current date and time
- Set the alarm so that the phone rings at a specific time (to remind you of an appointment for example)
- Use the phone as a calculator
- Assign functions to the navigation keys so that they can be used as shortcuts giving direct access to your favourite menus

Calendar



Menu 5.1

With the Calendar feature, you can:

- Consult the calendar
- Write memos to keep track of your schedule and trigger an alarm if necessary

Consulting the Calendar

When you select the **Calendar** menu option (5.1), the calendar is displayed. The following options are available when you press the **Options** soft key.

Search all: displays all memos set, regardless of the day and starting with the oldest. To scroll through the memos, press the  and  keys.



Delete all: allows you to delete all memos. You are asked to confirm your action.

Go to date: allows you to jump to a specific date.

Writing a Memo

To write or edit a memo on a specific date, proceed as follows.

1. Select the required date in the calendar, using the navigation keys.

Note: To skip to the previous or next month, press the  or  key on the left side of the phone.

2. Press the **Select** soft key.
An empty memo screen is displayed to allow you to enter your memo.

3. Enter your memo and then press the **OK** soft key.

Note: For further details on how to enter characters, refer to page 41.

You are asked if you wish to set the alarm.

4. If you want the alarm to ring on the chosen day, press the **Yes** soft key.
Otherwise, press the **No** soft key.
5. If you pressed **Yes**, set the time for the alarm and press **OK**.
A check mark is displayed in front of the date in the calendar to indicate that a memo exists.

Editing a Memo

If you select a day for which a memo already exists, you can press the **Edit** soft key to edit the memo displayed.

Note: For further details on how to enter characters, refer to page 41.

Once you have finished editing the memo, press the **OK** soft key. The following options are then available when you press the **Options** soft key.

Alarm: allows you to set the alarm to ring on the chosen day.

Erase: allows you to delete the memo.

Copy to: allows you to copy the memo to another date and/or time.

Move to: allows you to change the date and/or time of the memo.

To Do List

Menu 5.2

This feature allows you to:

- Draw up a list of tasks to be done
- Assign a priority and deadline to each task
- Sort the tasks by priority and status mark (for tasks to be done, for completed tasks)

Creating the To Do List



To create the To Do List, proceed as follows.

1. Press the **New** soft key.

2. Enter the first task.

Note: For further details on how to enter characters, see page 41.

3. Press the **OK** soft key.

4. Select high or low priority using the  or  key and the **Select** soft key.

5. Enter your deadline.

If you want to skip this step, press the **Skip** soft key. The task is saved without the deadline.

6. When entering is completed, press the **OK** soft key to save the task.

Editing the To Do List

If tasks are already defined in the To Do List when you select the **To Do List** menu option (5.2), the current contents are displayed with the associated status mark and priority. The following options are available.

To...	Then...
View the details for a specific task	<ul style="list-style-type: none"> Highlight the task. Press the View soft key.
Change the status of a specific task (<input type="checkbox"/> or <input checked="" type="checkbox"/>)	<ul style="list-style-type: none"> Highlight the task. Press the * key to mark the task as completed as of the current date and time.
	<p><u>or</u></p> <ul style="list-style-type: none"> Highlight the task. Press the Options soft key. Select the Mark option. Select the appropriate status.
Create a new task	<ul style="list-style-type: none"> Press the Options soft key. Select the New option. Enter the text, priority and deadline for the task.
Edit an existing task	<ul style="list-style-type: none"> Highlight the task. Press the Options soft key. Select the Edit option. Change the text, priority and deadline for the task.

To...

Sort the existing tasks by priority or status

Copy a task

Delete a task

Delete all tasks

Then...

- Press the **Options** soft key.
- Select the **Sort** option.
- Select the sort criterion (high, low, done, undo).
- Highlight the task.
- Press the **Options** soft key.
- Select the **Copy** option.
- Change the text, priority and deadline for the task as required.
- Highlight the task.
- Press the **Options** soft key.
- Select the **Delete** option.
- Press the **Options** soft key.
- Select the **Delete all** option.
- Confirm the deletion by pressing **OK**.

Time & Date

Menu 5.3

This option allows you to change the current time and date displayed. You can also check the current time for Greenwich Mean Time (GMT) and 21 major cities around the world.

The following options are available.

Set Time: allows you to enter the current time. You can choose the time format via Format menu option (5.3.4).

Note: Before setting the time, you must specify your time zone, via the **World Time** menu option (5.3.3).

Set Date: allows you to enter the day, month and year. You can change the date format via the **Format** menu option (5.3.4).

World Time: allows you to check the current time for Greenwich Mean Time (GMT) and 21 major cities around the world, using the ◀ and ▶ keys.

The screen shows the:

- City name
- Current date and time
- Time difference between the selected city and your city if you have set the local time (see below for further details) or GMT (by default)

To select the time zone in which you are located, proceed as follows.

1. Select the city corresponding to your time zone by pressing the ◀ or ▶ key one or more times. The local date and time are displayed.
2. Press the **Set** soft key.

Format: allows you to change the time and date formats.

Time format: 24 Hours
12 Hours

Date format: YYYY/MM/DD (year/month/day)
DD/MM/YYYY (day/month/year)
MM/DD/YYYY (month/day/year)

Alarm

Menu 5.4

This feature allows you to:

- Set the alarm to ring at a specific time
- Set the phone to switch on automatically and ring the alarm even if the phone is switched off (**Autopower** menu option set to **Enable**)

In the **Alarm** menu, the following options are available.

Once Alarm: the alarm rings only once and is then deactivated.

Daily Alarm: the alarm rings every day at the same time.

Weekly Alarm: the alarm rings every week on the same day and at the same time.

To set the alarm, proceed as follows.

1. Choose the alarm frequency option.
2. Enter the required time and day of the week (if applicable).

To stop the alarm when it rings, open the flip and press the **Exit** soft key.

Remove Alarm: deactivates the alarm.

Autopower: if this option is set to **Enable**, switches the phone on automatically only when the alarm rings and then switches the phone back off.

If the menu option is set to **Disable** and the phone is switched off at the specified time, the alarm will not ring.

Calculator

Menu 5.5

Using this feature, you can use the phone as a calculator. The calculator provides the basic arithmetic functions: addition, subtraction, multiplication and division.

Using the Calculator

1. Enter the first number using the numeric keys.
2. Press the right soft key until the required arithmetic symbol appears: + (add), - (subtract), x (multiply), / (divide).
3. Enter the second number.
4. Repeat Steps 1 to 3 as many times as required.

Notes:

- To erase any mistakes and clear the display, press the **C** key.
 - To include a decimal point or a bracket, press the left soft key until the required symbol is displayed.
5. To calculate the result, press the  key.

ShortCut

Menu 5.6

The down, left and right navigation keys and the **C** key can also be used as shortcut keys. When held down in idle mode, they allow you to access specific menu options directly.

Using the **ShortCut** menu option (5.6), the following menu options can be assigned to the shortcut keys:

- **None**
- **Silent mode** (Vibration setting (3.4.3) in Alert Type menu option)
- **Calendar** (menu option 5.1)
- **Calculator** (menu option 5.5)
- **Messages** (menu option 2)
- **Sound Settings** (menu option 3)
- **Games** (menu option 9.1)
- **To Do List** (menu option 5.2)
- **Voice Mail** (menu option 2.6)
- **Broadcast** (menu option 2.5)
- **Infrared Activate** (menu option 4.2)
- **Health** (menu option 9.2)

1. Select the key to be used as a shortcut key:
 - Key down (▼)
 - Key right (▶)
 - Key left (◀)
 - **C** long press (held down)
2. Select the menu option to be assigned to the key.

Note: To deactivate a shortcut key, select the **None** option.

Security

The Security feature enables you to restrict the use of your phone to:

- The people of your choice
- The types of calls of your choice

Various codes and passwords are used to protect the features of your phone. They are described in the following sections (see also pages 127-129).

PIN Check

Menu 6.1

When the PIN Check feature is enabled, you must enter your PIN each time you switch the phone on. Consequently, any person who does not have your PIN cannot use your phone without your approval.

Note: Before disabling the PIN Check feature, you must enter your PIN.

To change your PIN, refer to menu option **6.2**.

The following options are available.

Disable: the phone connects directly to the network when you switch it on.

Enable: you must enter the PIN each time the phone is switched on.

Change PIN

Menu 6.2

This feature allows you to change your current PIN to a new one, provided that the PIN Check feature is enabled. You must enter the current PIN before you can specify a new one.

Once you have entered a new PIN, you are asked to confirm it by entering it again.

Phone Lock

Menu 6.3

When the Phone Lock feature is enabled, the phone is locked and you must enter the 8-digit phone password each time the phone is switched on.

The password is factory set to 00000000. To change the phone password, refer to menu option **6.4** on the following page.

Once the correct password has been entered, you can use the phone until you switch it off.

The following options are available.

Disable: you are not asked to enter the phone password when you switch the phone on.

Enable: you are required to enter the phone password when you switch the phone on.

Change Password

Menu 6.4

The Change Password feature allows you to change your current phone password to a new one. You must enter the current password before you can specify a new one.

The password is factory set to 00000000. Once you have entered a new password, you are asked to confirm it by entering it again.

SIM Lock

Menu 6.5

When the SIM Lock feature is enabled, your phone only works with the current SIM. You must enter the SIM lock code.

Once you have entered the lock code, you are asked to confirm it by entering it again.

To unlock the SIM, you must enter the SIM lock code.

FDN Mode

Menu 6.6

The FDN (Fixed Dial Number) mode, if supported by your SIM card, allows you to restrict your outgoing calls to a limited set of phone numbers.

The following options are available.

Disable: you can phone any number.

Enable: you can only call phone numbers stored in the phonebook. You must enter your PIN2.

Note: Not all SIM cards have a PIN2. If your SIM card does not, this menu option is not displayed.

To change your PIN2, refer to menu option **6.7** below.

Change PIN2

Menu 6.7

The Change PIN2 feature allows you to change your current PIN2 to a new one. You must enter the current PIN2 before you can specify a new one.

Once you have entered a new PIN2, you are asked to confirm it by entering it again.

Note: Not all SIM cards have a PIN2. If your SIM card does not, this menu option is not displayed.

Network Services

These menu functions are network services. Please contact your service provider to check their availability and subscribe to them, if you so wish.

Call Diverting

Menu 7.1

This network service enables incoming calls to be rerouted to the number that you specify.

Example: You may wish to divert your business calls to a colleague while you are on holiday.

Call diverting can be set up in the following ways.

Divert Always: all calls are diverted.

Busy: calls are diverted if you are already making another call.

No Reply: calls are diverted if you do not answer the phone.

Unreachable: calls are diverted if you are not in an area covered by your service provider.

Cancel All: all call diverting options are cancelled.

You can specify individual diverting options for each of the following call types:

- Voice calls only
- Fax calls only
- Data calls only

Example: You can:

- Systematically divert fax calls to your office fax machine
- Divert voice calls to your colleague if you are already using the phone

To set your call diverting options, proceed as follows.

1. Select the type of call diverting required by pressing the ▲ or ▼ key until the appropriate option is highlighted and then press **Select**.
2. Select the type of calls to be diverted by pressing the ▲ or ▼ key until the appropriate option is highlighted and then press **Select**.

The current status is displayed. If the option has already been set, the number to which the calls are diverted is displayed.

3. **To...** **Then...**

Activate call diverting	<ul style="list-style-type: none"> • Press the Activate soft key. • Go to step 4.
Change the call number	<ul style="list-style-type: none"> • Press the Change soft key. • Go to step 4.
Deactivate call diverting	Press the Remove soft key.
4. Enter the number to which the calls are to be diverted and press **OK**.
To enter the international code, press the **0** key until the + sign is displayed.

The phone sends your settings to the network and the network's acknowledgement is displayed.

You can deactivate all call diverting settings by selecting the **Cancel All** option.

Call Barring

Menu 7.2

The call barring network service allows you to restrict your calls.

Call barring can be set up in the following ways.

All Outgoing: calls cannot be made.

International: international calls cannot be made.

International Except to Home: when abroad, calls can be made only to numbers within the current country and to your home country, that is the country where your home network provider is located.

All Incoming: calls cannot be received.

Incoming While Abroad: calls cannot be received when you are using your phone outside your home service area.

Cancel All: all call barring settings are deactivated; calls can be made and received normally.

You can specify individual barring options for each of the following call types:

- Voice calls only
- Fax calls only
- Data calls only

To set your call barring options, proceed as follows.

1. Select the type of call barring required by pressing the ▲ or ▼ key until the appropriate option is highlighted and then press **Select**.

2. Select the type of calls to be barred by pressing the ▲ or ▼ key until the appropriate option is highlighted and then press **Select**.
3. Press the **Activate** soft key to confirm your settings.
4. Enter your call barring password supplied by your service provider.

The phone sends your settings to the network and the network's acknowledgement is displayed.

To deactivate specific call barring settings, proceed as follows.

1. Select the call barring option to be deactivated.
2. Select the type of call to which this option applies.
3. Press the **Deactivate** soft key.
4. Enter your call barring password supplied by your service provider.

The phone sends your settings to the network and the network's acknowledgement is displayed.

You can also deactivate all call barring settings by selecting the **Cancel All** option.

Change Barring Password: you can set and change the call barring password obtained from your service provider using this option. You must enter the current password before you can specify a new one.

Once you have entered a new password, you are asked to confirm it by entering it again.

Call Waiting

Menu 7.3

This network service enables you to be informed when someone is trying to reach you during another call.

You can specify the call waiting option for voice calls only.

To set your call waiting options, proceed as follows.

1. Select the **Voice Calls** option by pressing the **Select** soft key.

The screen informs you whether call waiting is activated or deactivated.

2. You can activate or deactivate the call waiting feature as necessary using the **Activate** or **Deactivate** soft key respectively.

To return to the previous screen, press the **Exit** soft key.

You can also deactivate all call waiting settings by selecting the **Cancel All** option.

Network Selection

Menu 7.4

The Network Selection feature enables you to indicate whether the network used when roaming (outside your home area) is selected automatically or manually.

Note: You can select a network other than your home network only if it has a valid roaming agreement with your home network.

To indicate whether the network is to be selected automatically or manually when roaming, proceed as follows.

1. When **Network Selection** is displayed, press the **Select** soft key.
2. Press the ▲ or ▼ key until the appropriate option is highlighted and then press the **OK** soft key.

If you select **Automatic**, you are connected to the first available network when roaming.

If you select **Manual**, the phone scans for the available networks. Go to Step 3.

3. Press the ▲ or ▼ key until the preferred network is highlighted and then press the **OK** soft key.

You are connected to that network.

Caller ID

Menu 7.5

You can prevent your phone number from being displayed on the phone of the person being called.

Note: Some networks do not allow the user to change this setting.

The following options are available.

Default: the default setting provided by the network is used.

Hide Number: your number is not displayed on the other person's phone.

Send Number: your number is sent each time you make a call.

Closed User Group (CUG)

Menu 7.6

This network service allows incoming and outgoing calls to be restricted to a selected user group. You may be a member of up to ten user groups.

For details on how to create, activate and use a closed user group, contact your service provider.

Example: A company lends SIM cards to its employees and wants to restrict outgoing calls to members of the same team.

Activating a Closed User Group

If you select the **Closed User Group** menu, you can enter the CUG function. You can now access the following options after pressing the **Select** soft key.

Index List: lets you list, add or delete CUG index numbers. The list of current CUG indexes appears. Add a new CUG index (as advised by your service provider) or delete a selected group.

To...

Scroll through the existing CUG indexes

Add a new CUG index

Then press the...

▲ or ▼ key.

Options soft key, select the **Add** option and enter the index.

To...	Then press the...
Delete a CUG index	Options soft key and select the Delete option.
Activate a CUG index	Options soft key and select the Activate option.

Outside Access: lets you enable or disable calls to numbers other than those nominated for the Closed User Group. This feature depends on the nature of your CUG subscription. Please check with your service provider.

Default Group: you may communicate a default CUG to your service provider. If you have done so, you can enable the **Default Group** option on your phone. When making a call, you will be given the option of using your default CUG, instead of selecting one from the list.

Deactivate: deactivates the CUG function. This menu appears only when the default group is enabled or a CUG index is selected.

WAP Browser

Your phone is equipped with a WAP Browser to allow you to access and navigate the Wireless Web via your phone.

For further details on the WAP Browser menu, refer to the WAP Browser User's Manual supplied with your phone.

Life

The Life feature enables you to:

- enjoy some games.
- check your physical condition to keep your health.

Games

Menu 9.1

Using this feature, you can play four different games with the phone:

- Sniper
- Snake
- Mole
- Othello

Once you have selected a game, the following options are available.

Play: allows you to start a game.

Level (only in Sniper and Snake): allows you to select the level of difficulty. Select the required level using the ▲ and ▼ keys and press the **OK** soft key. This option is only available in games with several levels.

Configuration: allows you to configure the phone for the chosen game (backlight and sound settings). To adjust each setting, highlight the **Backlight** or **Sound** option by pressing the ▲ or ▼ key and then toggle between **ON** and **OFF** by pressing the **On/Off** soft key.

Instructions: describes the buttons used by the game. If necessary, press the ▲ or ▼ key to see a more detailed description.

High Score: enables you to view the highest score recorded for the selected game. You can also reset this score by pressing the **Reset** soft key.

If you break the current record for the game, the phone displays the High Score screen.

To stop playing a game, press the **C** or  key.

Health

Menu 9.2

Using this menu, you can check your body condition, such as bio rhythm, fatness index, and Pink schedule. Also, this menu can be helpful to keep your health by checking and counting how much calories some exercises or daily works consume.

Bio Rhythm

You can check the physical, emotional, or intellectual rhythm of your body for today or a specified day. To check the bio rhythm, you must enter your birthday in **Setup** menu option (9.2.1.3) first.

The following options are available.

Today: shows today's bio rhythm.

Special day: shows a specified day's bio rhythm. Enter the desired date and press the **OK** soft key. You must enter the date in order of day, month, and year.

Setup: Enter the date of your birthday. You must enter the date in order of day, month, and year.

Help: shows the cycles of the each types of the bio rhythm.

Fatness

Using this feature, you can check the fatness index of your body.

The following options are available.

Calculate: allows you to calculate your fatness degree for your height and weight.

To calculate the fatness index, proceed as follows.

1. Select your gender, **Male** or **Female** using the ▲ and ▼ keys, and press the **Select** soft key.
2. Enter your weight using the numeric keys, and press the **OK** soft key.
3. Enter your height using the numeric keys, and press the **OK** soft key.
4. The phone calculates your fatness index for your height and displays the result.
5. Press the **OK** soft key and the phone shows the fatness status of your body.
6. Press the  key to return to idle mode.

Help: tells you what the result means. Press the ◀ or ▶ key to move the black bar to the number cell according to the result.

Calorie

You can check and count how much calories the selected exercise or daily work consumes.

To calculate the caloric value, proceed as follows.

1. Select **Exercise** or **Daily work** using the ▲ and ▼ keys and press the **Select** soft key.
2. Press the ▲ or ▼ key to select a desired exercise or daily work, and press the **Select** soft key.
3. You can find the calorie value which the exercise or daily work for 10 minutes represents. If necessary, enter the desired length of time and press the **OK** soft key.
4. The phone displays the total calorie value according to the length of time you have entered. Press the **OK** soft key.
5. If necessary, repeat steps 1 to 4 to check calories of other works or exercises.
6. When you have finished adding the items, select **Total** by pressing the ▲ or ▼ key, and press the **Select** soft key to view the sum total.

Note: If you want to reset the sum total to resume calculation, press the **Reset** soft key.

Pink Schedule

Using this feature, you can set your menstrual period and check your physical schedule, such as the ovulation day, today's pregnancy probability, the pregnancy period and next menses day.

Note: The schedule may not fit to your physical condition. Therefore, use this Pink schedule just for reference.

The following options are available:

My Schedule: allows you to check your schedule.

Friend's Schedule: allows you to check the schedule of your friend's.

Setup: allows you to set up your menstrual schedule. To check your physical schedule, you must set up your menstrual schedule first.

To set up your menstrual schedule, proceed as follows.

1. Press the ▲ or ▼ key to select **Setup**, and press the **Select** soft key.
2. Enter the starting day of your last menstruation, and press the **OK** soft key.

Note: Enter the date in order of day, month, and year.

3. Enter your average menstrual period, and press the **OK** soft key.

To check your pink schedule, proceed as follows.

1. Press the **Select** soft key when **My Schedule** is highlighted.
2. Press the ▲ or ▼ key to select the desired one of the following schedule items and press the **Select** soft key.
 - Pregnant probability
 - Pregnancy period
 - Ovulation day
 - Next mense day
3. After checking, press the **OK** soft key.

To check the pink schedule of your friend's, proceed as follows.

1. Press the ▲ or ▼ key to select **Friend's Schedule**, and press the **Select** soft key.
2. Enter the starting day of her last menstruation, and press the **OK** soft key.

Note: Enter the date in order of day, month, and year.
3. Enter your average menstrual period, and press the **OK** soft key.
4. Press the ▲ or ▼ key to select the desired one of the schedule items and press the **Select** soft key.
5. After checking, press the **OK** soft key.

Solving Problems

Before contacting the after-sales service, perform the following simple checks. They may save you the time and expense of an unnecessary service call.

When you switch your phone on, the following messages may appear

Insert SIM Card

- Check that the SIM card is correctly installed.

Phone Locked

Enter Password

- The automatic locking function has been enabled. You must enter the phone's password before you can use the phone.

Enter PIN

- You are using your phone for the first time. You must enter the Personal Identification Number supplied with the SIM card.
- The option requiring that the PIN be entered each time the phone is switched on was enabled. You must enter your PIN and then disable this option if so required.

Enter PUK

- The PIN code was entered wrongly three times in succession and the phone is now blocked. Enter the PUK supplied by your network operator.

"No service", "Network failure" or "Not done" is displayed

- The network connection was lost. You may be in a weak signal area (in a tunnel or surrounded by buildings). Move and try again.
- You are trying to access an option for which you have not taken out a subscription with your service provider. Contact the service provider for further details.

You have entered a number but it was not dialled

- Have you pressed the  key?
- Are you accessing the right cellular network?
- You may have set an outgoing call barring option.

Your correspondent cannot reach you

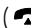
- Is your phone switched on (/ⓧ pressed for more than one second)?
- Are you accessing the right cellular network?
- You may have set an incoming call barring option.

Your correspondent cannot hear you speaking

- Have you switched off the microphone?
- Are you holding the phone close enough to your mouth? The microphone is located at the bottom of the phone.

The phone starts beeping and “**Warning** Low Battery” flashes in the display

- The battery is insufficiently charged. Replace the battery and recharge it.

The audio quality of the call is poor

- Check the signal strength indicator in the display (); the number of bars after it indicates the signal strength from strong () to weak ().
- Try moving the phone slightly or moving closer to a window if you are in a building.

No number is dialled when you recall a phonebook entry

- Check that the numbers have been stored correctly, by using the Phonebook Search feature.
- Re-store the number, if necessary.

If the above guidelines do not enable you to solve the problem, take a note of:

- The model and serial numbers of your phone
- Your warranty details
- A clear description of the problem

Then contact your local dealer or SAMSUNG after-sales service.

Access Codes

There are several access codes that are used by your phone and its SIM card. These codes help you protect the phone against unauthorised use.

The access codes (except for the PUK and PUK2 codes) can be changed using the Security (**Menu 6**) menu options. See page 104 for further details.

Phone Password

The security code can be used to avoid unauthorised use of your phone. The security code 00000000 is usually supplied with the phone. Change the security code before you start using your phone. Keep the new code secret and in a safe place, which is separate from the phone.

If you key in an incorrect security code five times in succession, the phone will not accept the correct code for the next five minutes.

PIN code

The PIN (Personal Identification Number) code protects your SIM card against unauthorised use. The PIN code is usually supplied with the SIM card. When the PIN code request is enabled (**Menu 6-1**), the code is asked each time the phone is switched on.

If you key in an incorrect PIN code three times in succession, key in the PUK code and press **OK**. Key in a new PIN code and press **OK**. Key in the new code again and press **OK**.

PIN2 code

The PIN2 code, supplied with some SIM cards, is required to access some functions, such as charging unit counters. These functions are only available if supported by your SIM card.

If you key in an incorrect PIN2 code three times in succession, key in the PUK2 code and press **OK**. key in a new PIN2 code and press **OK**. Key in the new code again and press **OK**.

PUK code

The PUK (Personal Unblocking Key) code is required to change a blocked PIN code. The PUK code may be supplied with the SIM card. If not, contact your local service provider for the code.

If you key in an incorrect PUK code ten times in succession, the SIM card cannot be used anymore. Contact your service provider for a new card.

You cannot change the PUK code. If you lose the code, contact your service provider.

PUK2 code

The PUK2 code, supplied with some SIM cards, is required to change a blocked PIN2 code.

If you key in an incorrect PUK2 code ten times in succession, you cannot use the functions requiring the PIN2 code. Contact your service provider for a new card.

You cannot change the PUK2 code. If you lose the code, contact your service provider.

Barring Password

The 4-digit barring password is required when you use the Call Barring function. You obtain the password from your service provider when you subscribe to this function.

Health and Safety Information

Exposure to Radio Frequency (RF) Signals

Your mobile phone is a radio transmitter and receiver. It is designed and manufactured not to exceed the emission limits for exposure to radio frequency (RF) energy set by the Federal Communications Commission of the U.S. Government. These limits are part of comprehensive guidelines and establish permitted levels of RF energy for the general population. Those guidelines are consistent with the safety standard previously set by both U.S. and international standards bodies:

- American National Standards Institute (ANSI) IEEE. C95.1-1992
- National Council on Radiation Protection and Measurement (NCRP). Report 86
- International Commission on Non-Ionizing Radiation Protection (ICNIRP) 1996
- Ministry of Health (Canada), Safety Code 6.

The standards include a substantial safety margin designed to assure the safety of all persons, regardless of age and health.

The exposure standard for wireless mobile phones employs a unit of measurement known as the Specific Absorption Rate, or SAR. The SAR limit set by the FCC is 1.6W/kg.*

* In the U.S. and Canada, the SAR limit for mobile phones used by the public is 1.6 watts/kg(w/kg) averaged over one gram of tissue. The standard incorporates a substantial margin of safety to give additional protection for the public and to account for any variations in measurements.

Tests for SAR are conducted using standard operating positions specified by the FCC with the phone transmitting at its highest certified power level in all tested frequency bands. Although the SAR is determined at the highest certified power level, the actual SAR level of the phone while operation can be well below the maximum value. This is because the phone is designed to operate at multiple power levels so as to use only the power required to reach the network. In general, the closer you are to a wireless base station antenna, the lower the power output.

Before a phone model is available for sale to the public, it must be tested and certified to the FCC that it does not exceed the limit established by the government-adopted requirement for safe exposure. The tests are performed in positions and locations (e.g., at the ear and worn on the body) as required by the FCC for each model. (Body-worn measurements differ among phone models, depending upon available accessories and FCC requirements). While there may be differences between the SAR levels of various phones and at various positions, they all meet the government requirement for safety exposure.

For body worn operation, to maintain compliance with FCC RF exposure guidelines, use only Samsung-approved accessories. When carrying the phone while it is on, use the specific Samsung belt-clip that has been tested for compliance.

Use of non-SAMSUNG-approved accessories may violate FCC RF exposure guidelines and should be avoided.

For additional information concerning exposure to radio frequency signals, see the following websites:

Federal Communications Commission (FCC) RF Safety program (select "Information on Human Exposure to RF Fields from Cellular and PCS Radio Transmitters"):
<http://www.fcc.gov/oet/rfsafety>

Cellular Telecommunications Industry Association (CTIA): <http://www.wow-com.com>

World Health Organization (WHO) International Commission on Non-ionizing Radiation Protection (select Qs & As):
<http://www.who.int/emf>

United Kingdom, National Radiological Protection Board: <http://www.nrpb.org.uk>

U.S. Food and Drug Administration (FDA) Center for Devices and Radiological Health:
<http://www.fda.gov/cdrh/consumer/>

Precautions When Using Batteries

Your phone is powered by a rechargeable Li-ion standard battery.

- Never use any charger or battery that is damaged in any way.
- Use the battery only for its intended purpose.
- If you use the phone near the network's base station, it uses less power; talk and standby times are greatly affected by the signal strength on the cellular network and the parameters set by the network operator.
- Battery charging times depend on the remaining battery charge and the type of battery and charger used. The battery can be charged and discharged hundreds of times, but it will gradually wear out. When the operation time (talk time and standby time) is noticeably shorter than normal, it is time to buy a new battery.
- If left unused, a fully charged battery will discharge itself over time.
- Use only Samsung-approved batteries and recharge your battery only with Samsung-approved chargers. When a charger is not in use, disconnect it from the power source. Do not leave the battery connected to a charger for more than a week, since overcharging may shorten its life.

- Extreme temperatures will affect the charging capacity of your battery: it may require cooling or warming first.
- Do not leave the battery in hot or cold places, such as in a car in summer or winter conditions, as you will reduce the capacity and life-time of the battery. Always try to keep the battery at room temperature. A phone with a hot or cold battery may temporarily not work, even when the battery is fully charged. Li-ion batteries are particularly affected by temperatures below 0 °C (32 °F).
- Do not short-circuit the battery. Accidental short circuiting can occur when a metallic object (coin, clip or pen) causes a direct connection between the + and - terminals of the battery (metal strips on the back of the battery), for example when you carry a spare battery in a pocket or bag. Short-circuiting the terminals may damage the battery or the object causing the short-circuit.
- Dispose of used batteries in accordance with local regulations. Always recycle. Do not dispose of batteries in a fire.

Road Safety

Your wireless phone gives you the powerful ability to communicate by voice-almost anywhere, anytime. But an important responsibility accompanies the benefits of wireless phones, one that every user must uphold.

When driving a car, driving is your first responsibility. When using your wireless phone behind the wheel of a car, practice good common sense and remember the following tips:

1. Get to know your wireless phone and its features such as speed dial and redial. If available, these features help you to place your call without taking your attention off the road.
2. When available, use a hands-free device. If possible, add an additional layer of convenience and safety to your wireless phone with one of the many hands-free accessories available today.
3. Position your wireless phone within easy reach. Be able to access your wireless phone without removing your eyes from the road. If you get an incoming call at an inconvenient time, if possible, let your voice mail answer it for you.
4. Let the person you are speaking with know you are driving; if necessary, suspend the call in heavy traffic or hazardous weather conditions. Rain, sleet, snow, ice, and even heavy traffic can be hazardous.

5. Do not take notes or look up phone numbers while driving. Jotting down a “to do” list or flipping through your address book takes attention away from your primary responsibility, driving safely.
6. Dial sensibly and assess the traffic; if possible, place calls when you are not moving or before pulling into traffic. Try to plan calls when your car will be stationary. If you need to make a call while moving, dial only a few numbers, check the road and your mirrors, and continue.
7. Do not engage in stressful or emotional conversations that may be distracting. Make people you are talking with aware you are driving and suspend conversations that have the potential to divert your attention from the road.
8. Use your wireless phone to call for help. Dial 9-1-1 or other local emergency number in the case of fire, traffic accident or medical emergencies. Remember, it is a free call on your wireless phone!
9. Use your wireless phone to help others in emergencies. If you see an auto accident, crime in progress or other serious emergency where lives are in danger, call 9-1-1 or other local emergency number, as you would want others to do for you.

10. Call roadside assistance or a special non-emergencies wireless assistance number when necessary. If you see a broken-down vehicle posing no serious hazard, a broken traffic signal, a minor traffic accident where no one appears injured, or a vehicle you know to be stolen, call roadside assistance or other special non-emergency wireless number.

Operating Environment

Remember to follow any special regulations in force in any area and always switch off your phone whenever it is forbidden to use it, or when it may cause interference of danger.

When connecting the phone or any accessory to another device, read its user's guide for detailed safety instructions. Do not connect incompatible products.

As with other mobile radio transmitting equipment, users are advised that for the satisfactory operation of the equipment and for the safety of personnel, it is recommended that the equipment should only be used in the normal operating position (held to your ear with the antenna pointing over your shoulder).

Electronic Devices

Most modern electronic equipment is shielded from radio frequency (RF) signals. However, certain electronic equipment may not be shielded against the RF signals from your wireless phone.

Pacemakers

Pacemaker manufacturers recommend that a minimum separation of 6 inches (20 cm) be maintained between a hand-held wireless phone and a pacemaker to avoid potential interference with the pacemaker. These recommendations are consistent with the independent research by and recommendations of Wireless Technology Research.

Persons with pacemakers:

- Should always keep the phone more than 6 inches (15 cm) from their pacemaker when the phone is switched on;
- Should not carry the phone in a breast pocket;
- Should use the ear opposite the pacemaker to minimize the potential for interference.
- If you have any reason to suspect that interference is taking place, switch off your phone immediately.

Hearing Aids

Some digital wireless phones may interfere with some hearing aids. In the event of such interference, you may want to consult your hearing aid manufacturer to discuss alternatives.

Other Medical Devices

If you use any other personal medical device, consult the manufacturer of your device to determine if they are adequately shielded from external RF energy. Your physician may be able to assist you in obtaining this information. Switch off your phone in health care facilities when any regulations posted in these areas instruct you to do so. Hospitals or health care facilities may be using equipment that could be sensitive to external RF energy.

Vehicles

RF signals may affect improperly installed or inadequately shielded electronic systems in motor vehicles. Check with the manufacturer or its representative regarding your vehicle. You should also consult the manufacturer of any equipment that has been added to your vehicle.

Posted Facilities

Switch off your phone in any facility where posted notices so require.

Potentially Explosive Atmospheres

Switch off your phone when in any area with a potentially explosive atmosphere and obey all signs and instructions. Sparks in such areas could cause an explosion or fire resulting in bodily injury or even death.

Users are advised to switch off the phone while at a refueling point (service station). Users are reminded of the need to observe restrictions on the use of radio equipment in fuel depots (fuel storage and distribution areas), chemical plants or where blasting operations are in progress.

Areas with a potentially explosive atmosphere are often but not always clearly marked. They include below deck on boats; chemical transfer or storage facilities; vehicles using liquefied petroleum gas (such as propane or butane); areas where the air contains chemicals or particles, such as grain, dust or metal powders; and any other area where you would normally be advised to turn off your vehicle engine.

Vehicles

Only qualified personnel should service the phone, or install the phone in a vehicle. Faulty installation or service may be dangerous and may invalidate any warranty which may apply to the unit.

Check regularly that all mobile phone equipment on your vehicle is mounted and operating properly.

Do not store or carry flammable liquids, gases or explosive materials in the same compartment as the phone, its parts or accessories.

For vehicles equipped with an air bag, remember that an air bag inflates with great force. Do not place objects, including both installed or portable wireless equipment in the area over the air bag or in the air bag deployment area. If in-vehicle wireless equipment is improperly installed and the air bag inflates, serious injury could result.

Switch off your phone before boarding an aircraft. The use of mobile phones in an aircraft may be dangerous to the operation of the aircraft, disrupt the wireless telephone network and may be illegal.

Failure to observe these instructions may lead to the suspension or denial of telephone services to the offender, or legal action, or both.

Emergency Calls

Important!

This phone, like any mobile phone, operates using radio signals, wireless and landline networks as well as user-programmed functions which cannot guarantee connection in all conditions. Therefore, you should never rely solely upon any wireless phone for essential communications (for example, medical emergencies).

Remember, to make or receive any calls the phone must be switched on and in a service area with adequate signal strength. Emergency calls may not be possible on all wireless phone networks or when certain network services and/or phone features are in use. Check with local service providers.

To make an emergency call:

1. If the phone is not on, switch it on.
2. Key in the emergency number for your present location (for example, 911 or other official emergency number). Emergency numbers vary by location.
3. Press <  >.

If certain features are in use (keyguard, restrict calls, etc.), you may first need to turn those features off before you can make an emergency call. Consult this document and your local cellular service provider.

When making an emergency call, remember to give all the necessary information as accurately as possible. Remember that your phone may be the only means of communication at the scene of an accident - do not cut off the call until given permission to do so.

Care and Maintenance

Your phone is a product of superior design and craftsmanship and should be treated with care. The suggestions below will help you to fulfill any warranty obligations and allow you to enjoy this product for many years. When using your phone, battery, charger, OR any accessory:

- Keep it and all its parts and accessories out of small children's reach.
- Keep it dry. Precipitation, humidity and liquids contain minerals that will corrode electronic circuits.
- Do not use or store it in dusty, dirty areas as its moving parts can be damaged.
- Do not store it in hot areas. High temperatures can shorten the life of electronic devices, damage batteries, and warp or melt certain plastics.
- Do not store it in cold areas. When the phone warms up (to its normal operating temperature), moisture can form inside the phone, which may damage the phone's electronic circuit boards.
- Do not drop, knock or shake it. Rough handling can break internal circuit boards.

- Do not use harsh chemicals, cleaning solvents, or strong detergents to clean it. Wipe it with a soft cloth slightly dampened in a mild soap-and-water solution.
- Do not paint it. Paint can clog the device's moving parts and prevent proper operation.
- Use only the supplied or an approved replacement antenna. Unauthorized antennas, modifications of attachments could damage the phone and may violate regulations governing radio devices.
- If the phone, battery, charger, or any accessory is not working properly, take it to your nearest qualified service facility. The personnel there will assist you, and if necessary, arrange for service.

Glossary

To help you understand the main technical terms and abbreviations used in this booklet and take full advantage of the features on your mobile phone, here are a few definitions.

Active Flip

Ability to answer a call simply by opening the phone.

Call Barring

Ability to restrict outgoing and incoming calls.

Call Diverting

Ability to reroute calls to another number.

Call Holding

Ability to put one call on standby while answering or making another call; you can then switch between the two calls, as required.

Call Waiting

Ability to inform users that they have an incoming call when engaged on another call.

DCS

Digital cellular network standard based on the GSM network architecture. With the higher frequency range (1800 MHz for DCS instead of 900 MHz for GSM), more radio channels can be made available, thus allowing the network to support more subscribers and traffic.

Dual Band

Ability to operate with both DCS (1800 MHz) and GSM (900 MHz) networks. The phone automatically uses the network with the strongest signal and even switches networks during a call within the same operator's network.

GSM (Global System for Mobile Communication)

International standard for cellular communication, guaranteeing compatibility between the various network operators. GSM covers most European countries and many other parts of the world.

Line Identification Services (Caller ID)

Services allowing subscribers to view or block the telephone numbers of callers.

Multiparty Calling

Ability to establish a conference call involving up to five additional parties.

Phone Password

Security code used to unlock the phone when you have selected the option to lock it automatically each time it switches on.

PIN (Personal Identification Number)

Security code that protects the phone against unauthorised use. The PIN is supplied by the service provider with the SIM card. It may be a four to eight-digit number and can be changed, as required.

PUK (PIN Unblocking Key)

Security code used to unlock the phone when an incorrect PIN has been entered three times in succession. The eight-digit number is supplied by the service provider with the SIM card.

Roaming

Use of your phone when you are outside your home area (when travelling for example).

SDN (Service Dialling Numbers)

Telephone numbers supplied by your network provider and giving access to special services, such as voice mail, directory inquiries, customer support and emergency services.

SIM (Subscriber Identification Module)

Card containing a chip with all the information required to operate the phone (network and memory information, as well as the subscriber's personal data). The SIM card fits into a small slot on the back of the phone and is protected by the battery.

SMS (Short Message Service)

Network service sending and receiving messages to and from another subscriber without having to speak to the correspondent. The message created or received (up to 160 characters long) can be displayed, received, edited or sent.

Soft Keys

Two keys (☺) on the phone, the purpose of which:

- Varies according to the function that you are currently using
- Is indicated on the bottom line of the display just above the corresponding key

Voice Mail

Computerised answering service that automatically answers your calls when you are not available, plays a greeting (optionally in your own voice) and records a message.



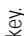
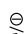
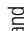
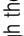
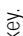

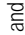
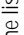
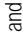
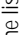

Dual Band SGH-A408 GSM Telephone Quick Reference Card

Switch On/Off	Press and hold  .
Make a Call	① Key in the number. ② Press the  key.
End a Call	Briefly press the  key.
View Missed Calls Immediately After Missing Them	① Open the phone and press the View soft key. ② Scroll with the  and  keys through the missed calls. ③ To return the call, press the  key.

Access the Menu Function	① Press the Menu soft key. ② Scroll with the  and  keys through the list of menus until you reach the required menu. ③ Press the Select soft key. ④ Scroll with the  and  keys through the list of options until the required one is selected. ⑤ Press the Select soft key to confirm.
--------------------------	--

- Each of the two soft keys (☺) performs the function indicated by the text above it (bottom line in the display).



<p>Answer a Call</p>	<p>Open the phone or Press the  key.</p>	<p>Store Numbers in the Phonebook</p>	<ol style="list-style-type: none"> ① Key in the number. ② Press the Save soft key. ③ Enter the name. ④ Press the OK soft key. ⑤ If necessary, change the location. ⑥ Press the OK soft key.
<p>Adjust the Volume</p>	<p>Press the  or  key on the left side of the phone.</p>		
<p>Choose the Alert Type</p>	<ol style="list-style-type: none"> ① Select the Alert Type menu option (3.4). ② Select an option: Light only, Melody, Vibration, Vibra+ Melody. ③ Press the Select soft key to confirm. 	<p>Search for a Number in the Phonebook</p>	<ol style="list-style-type: none"> ① Press the Name soft key. ② Enter the start of the name. ③ Press the Search soft key. ④ To scroll through the names, press the  and  keys. ⑤ To make a call, press the  key.